	<b>SIGNING SEQUENCE IN ADVANCE OF WATERCRAFT AND WATERCRAFT/VEHICLE INSPECTION STATIONS</b>		<i>Issued: APR 2018</i>
			<i>Revised:</i>
			<i>Page 1 of 6</i>
<b>RECOMMENDED PRACTICES</b>	PART	HIGHWAY SIGNS	
	SECTION	TYPICAL SIGNING PLANS	
	SUB-SECTION		

**General**

Under Section 33.2 (3) of the Fisheries Act, motorists carrying water-based vessel(s) are required to stop at Watercraft Inspection Stations. The purpose of this legislation is to ensure that invasive species are not transported between waterbodies.

Currently, many Watercraft Inspection Stations are located along provincial highways. In some cases, they are located at Vehicle Inspection Stations. Therefore, there is a need for proper signage to direct motorists to active Watercraft and Watercraft/Vehicle Inspection Stations.

Typical signing sequences were developed for both Watercraft Inspection Stations and Watercraft/Vehicle Inspection Stations. Both use similar sequences to the existing Recommended Practices Signing Sequence in Advance of Vehicle Inspection Stations (VIS & MIS) to ensure consistency.

**Application Process**

Alberta Environment and Parks (AEP) can apply for a permit for Watercraft Inspection Station or Watercraft/Vehicle Inspection Station signs. The application should be sent to the relevant district office. A map of the districts as well as the office contact information can be found at the following link:

<http://www.transportation.alberta.ca/4450.htm>

Upon approval, Alberta Transportation will issue a permit and arrange for the supply and installation of the signs through the

highway maintenance contractor(s).

**Standard for Watercraft Inspection Stations**

Watercraft Inspection Stations are preceded by one Dynamic Message Sign (DMS) and a series of static signs. The first sign that motorists will see is the DMS. The sign message on the DMS is variable and determined by AEP.

Approximately 300 m downstream of the DMS sign, the static sign sequence will begin. The first static sign in the sequence is the Watercraft Inspection Station 2 km sign (RB-79A), which consists of a black symbol and text on a white background.

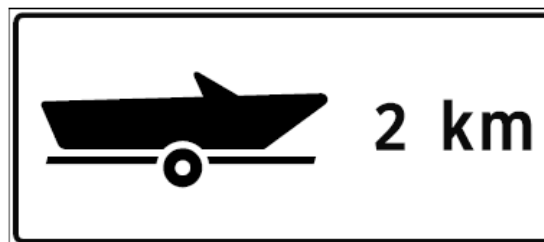

<b>RB-79A</b>	<b>2100 mm x 914 mm</b>	
<b>Colour</b>	Text and border Background	Black White
<b>Sheeting</b>	ASTM Type III or IV	

The RB-79A sign is accompanied by a “Watercraft Inspection Station” (RB-79A-T) tab sign that is placed beneath it on the same post.



<b>RB-79A-T</b>	<b>2100 mm x 610 mm</b>	
<b>Colour</b>	Text and border Background	Black White
<b>Sheeting</b>	ASTM Type III or IV	

Closer to the site of a Watercraft Inspection Station is the Watercraft Inspection Station sign (RB-78A), accompanied by either the Next Left or Next Right tab sign (RB-75-TL or RB-75-TR).

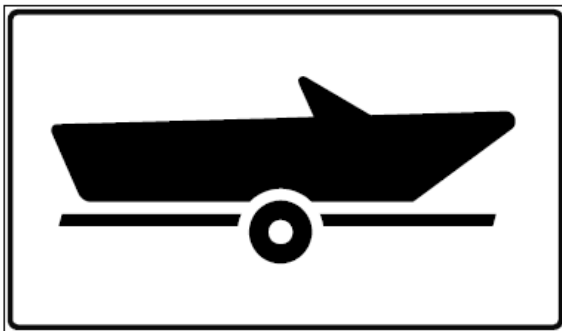

<b>RB-78-A</b>	<b>2100 mm x 914 mm</b>	
<b>Colour</b>	Text and border Background	Black White
<b>Sheeting</b>	ASTM Type III or IV	



<b>RB-75-TR</b>	<b>2100 mm x 610 mm</b>	
<b>Colour</b>	Text and border Background	Black White
<b>Sheeting</b>	ASTM Type III or IV	

The RB-81 “All Watercraft Report to Inspection Station” is accompanied by alternately flashing 300 mm amber light-

emitting diode (LED) lights (mounted near the corners on the top of the sign). When the lights are flashing, the Watercraft Inspection Station is open. The RB-81 sign is accompanied by a “When Lights Flashing” tab sign (RB-81-T).



<b>RB-81</b>	<b>2400 mm x 1530 mm</b>	
<b>Colour</b>	Text and border Background	Black White
<b>Sheeting</b>	ASTM Type III or IV	



<b>RB-81-T</b>	<b>2400 mm x 610 mm</b>	
<b>Colour</b>	Text and border Background	Black White
<b>Sheeting</b>	ASTM Type III or IV	

The RB-80A “Watercraft Inspection Station Next Exit” sign provides direction to vehicles carrying watercraft of the need to take the next exit. If the inspection station is accessed at an intersection via a sharp left turn, the RB-80A-L sign may be used in place of the RB-80 sign. The angle of the arrow on the RB-80 or RB-80-L should reflect the geometry of the access point.

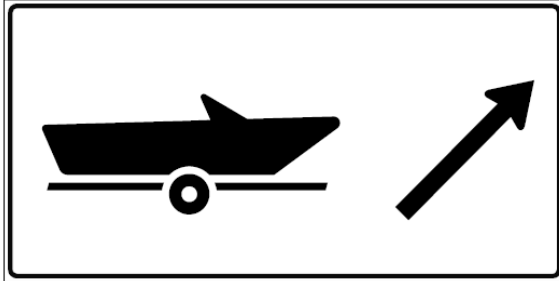

<b>RB-80A</b>	<b>2100 mm x 914 mm</b>	
<b>Colour</b>	Text and border Background	Black White
<b>Sheeting</b>	ASTM Type III or IV	

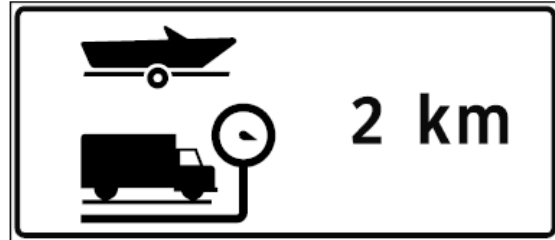

<b>RB-79B</b>	<b>2100 mm x 914 mm</b>	
<b>Colour</b>	Text and border Background	Black White
<b>Sheeting</b>	ASTM Type III or IV	

**Standard for Watercraft/Vehicle  
Inspection Stations**

Many Watercraft Inspection Stations are located at existing Vehicle Inspection Stations (VIS). For such stations, signs that have both the VIS symbol and a watercraft symbol are used. Watercraft/Vehicle Inspection Stations are preceded by one Dynamic Message Sign (DMS) and a series of static signs. The first sign that motorists will see is the DMS. The sign message on the DMS is variable and determined by Alberta Environment and Parks.

Approximately 300 m downstream of the DMS sign, the static sign sequence will begin. The first static sign in the sequence is the Watercraft/Vehicle Inspection Station 2 km sign (RB-79B), which consists of a black symbol and text on a white background.

The RB-79B sign is accompanied by a "Watercraft/Vehicle Inspection Station" (RB-79B-T) tab sign that is placed beneath it on the same post.



<b>RB-79B-T</b>	<b>2100 mm x 610 mm</b>	
<b>Colour</b>	Text and border Background	Black White
<b>Sheeting</b>	ASTM Type III or IV	

Closer to the site of a Watercraft/Vehicle Inspection Station is the Watercraft/Vehicle Inspection Station sign (RB-78B), accompanied by either the Next Left or Next Right tab sign (RB-75-TL or RB-75-TR).

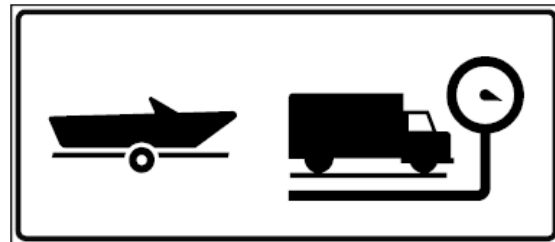

<b>RB-78B</b>	<b>2100 mm x 914 mm</b>	
<b>Colour</b>	Text and border Background	Black White
<b>Sheeting</b>	ASTM Type III or IV	



The RB-203 sign is accompanied by an Unless Exempted tab sign (RB-203T) which indicates to exempted vehicles (such as recreational vehicles and scheduled buses) that they are not required to stop.

<b>RB-75-TR</b>	<b>2100 mm x 610 mm</b>	
<b>Colour</b>	Text and border Background	Black White
<b>Sheeting</b>	ASTM Type III or IV	



<b>RB-203T</b>	<b>2400 x 450 mm</b>	
<b>Colour</b>	Text and border Background	Black White
<b>Sheeting</b>	ASTM Type III or IV	

The next sign in the sequence is the RB-203 “Vehicles Over 4500 kg Report to Vehicle Inspection Station When Lights Flashing”. This sign is accompanied by alternately flashing 300 mm amber light-emitting diode (LED) lights (mounted near the corners on the top of the sign) that indicate when it is mandatory for trucks to report for inspections. When the lights are not flashing, reporting for inspection or weighing is optional.

The RB-81 “All Watercraft Report to Inspection Station When Lights Flashing” follows the RB-203 sign. It is also accompanied by alternately flashing 300 mm amber light-emitting diode (LED) lights (mounted near the corners on the top of the sign). When the lights are flashing, the Watercraft Inspection Station is open. The RB-81 sign is accompanied by a “When Lights Flashing” tab sign (RB-81-T).



<b>RB-203</b>	<b>2400 x 1500 mm</b>	
<b>Colour</b>	Text and border Background	Black White
<b>Sheeting</b>	ASTM Type III or IV	

<b>RB-81</b>	<b>2400 x 1530 mm</b>	
<b>Colour</b>	Text and border Background	Black White
<b>Sheeting</b>	ASTM Type III or IV	

**WHEN LIGHTS FLASHING**

<b>RB-81-T</b>	<b>2400 x 610 mm</b>	
<b>Colour</b>	Text and border Background	Black White
<b>Sheeting</b>	ASTM Type III or IV	

The RB-80A “Watercraft/Vehicle Inspection Station Next Exit” sign provides direction to vehicles carrying watercraft of the need to take the next exit. If the inspection station is accessed at an intersection via a sharp left turn, the RB-80A-L sign may be used in place of the RB-80 sign. The angle of the arrow on the RB-80 or RB-80-L should reflect the geometry of the access point.

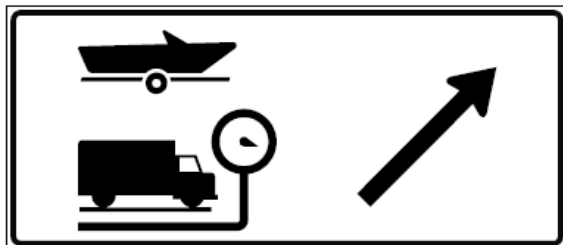

<b>RB-80B</b>	<b>2100 x 914 mm</b>	
<b>Colour</b>	Text and border Background	Black White
<b>Sheeting</b>	ASTM Type III or IV	

**Guidelines for Placement**

Watercraft and Watercraft/Vehicle Inspection Station signage should be placed within the highway right-of-way, in accordance with the Recommended Practices Placement of Signs guidelines. Installation of Watercraft and Watercraft/Vehicle Inspection Station signage should follow the typical signing drawings TEB 1.107 and TEB 1.108.

**Equipment Considerations**

The flashing LED lights (300 mm) used on the top of the RB-203 and RB-81 signs require a power source to function. Power can be obtained through hard-wiring, where a power source is available in the area, or through solar panels built into the light units.

Where the lights are hard-wired, the power board should be located at the fence line to avoid damage in the event of a vehicle running off the road.

LED lights used in conjunction with the RB-203 and RB-81 signs should be installed approximately 300 mm (12 inches) from the vertical sign edges.

To enhance the visibility of the flashing lights and reduce glare at locations where glare may be a concern, a black backboard should be used with the light unit.

**Installation and Maintenance**

AEP is responsible for all costs associated with the initial order, supply and install of new signs for Watercraft Inspection Station signs and Watercraft/Vehicle Inspection Station signs that are replacing existing VIS signs.

AEP will also be responsible for the costs of repairing or replacing signs or lightbulbs that have been damaged (for ex. vandalism, knockdowns, etc) or have reached their end of life for signs that only have the watercraft symbol. Alberta Transportation is responsible for the costs of replacement of signs or lightbulbs that are associated with Vehicle Inspection Stations (signs that contain only heavy vehicle symbols and signs that contain both watercraft and heavy vehicle symbols).

**References to Standards**

<i>Recommended Practices</i> Section: Typical Signing Plans	Signing Sequence in Advance of Vehicle Inspection Stations (VIS & MIS)
<i>Recommended Practices</i> Section: General	Placement of Signs

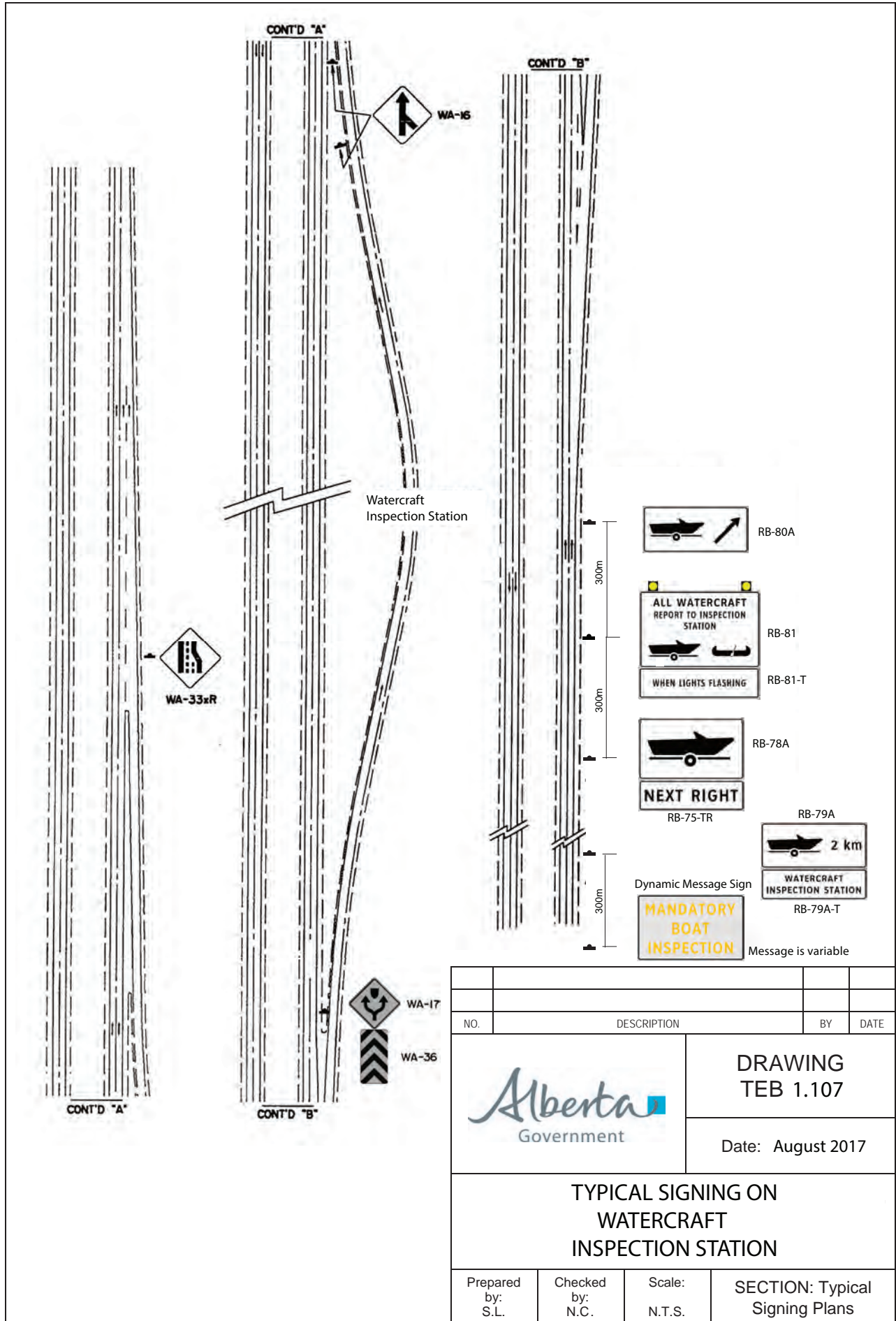

NO.	DESCRIPTION	BY	DATE
		<b>DRAWING</b> <b>TEB 1.107</b>	
		Date: August 2017	
<b>TYPICAL SIGNING ON WATERCRAFT INSPECTION STATION</b>			
Prepared by: S.L.	Checked by: N.C.	Scale: N.T.S.	SECTION: Typical Signing Plans

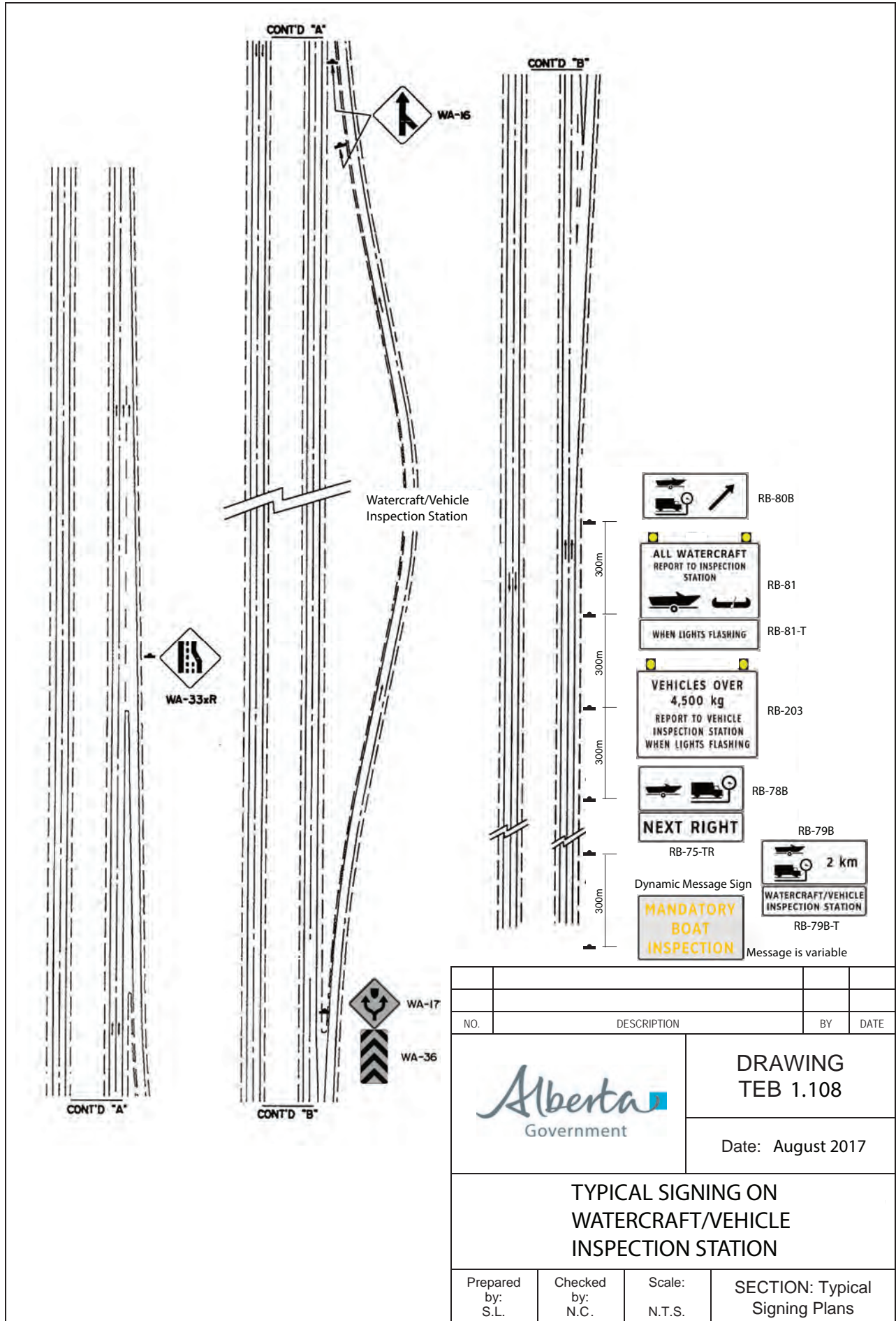

NO.	DESCRIPTION	BY	DATE
		<b>DRAWING</b> <b>TEB 1.108</b>	
		Date: August 2017	
<b>TYPICAL SIGNING ON WATERCRAFT/VEHICLE INSPECTION STATION</b>			
Prepared by: S.L.	Checked by: N.C.	Scale: N.T.S.	SECTION: Typical Signing Plans