

TANK PLAN
N.T.S.

- NOTES:**
- ALL DIMENSIONS SHOWN IN MILLIMETRES
 - PRECAST TANK TO CAN/CSA-B66-M90
 - TYPE HS CEMENT
 - WORK THESE DRAWINGS TOGETHER CB6-4.6M1 TO 20

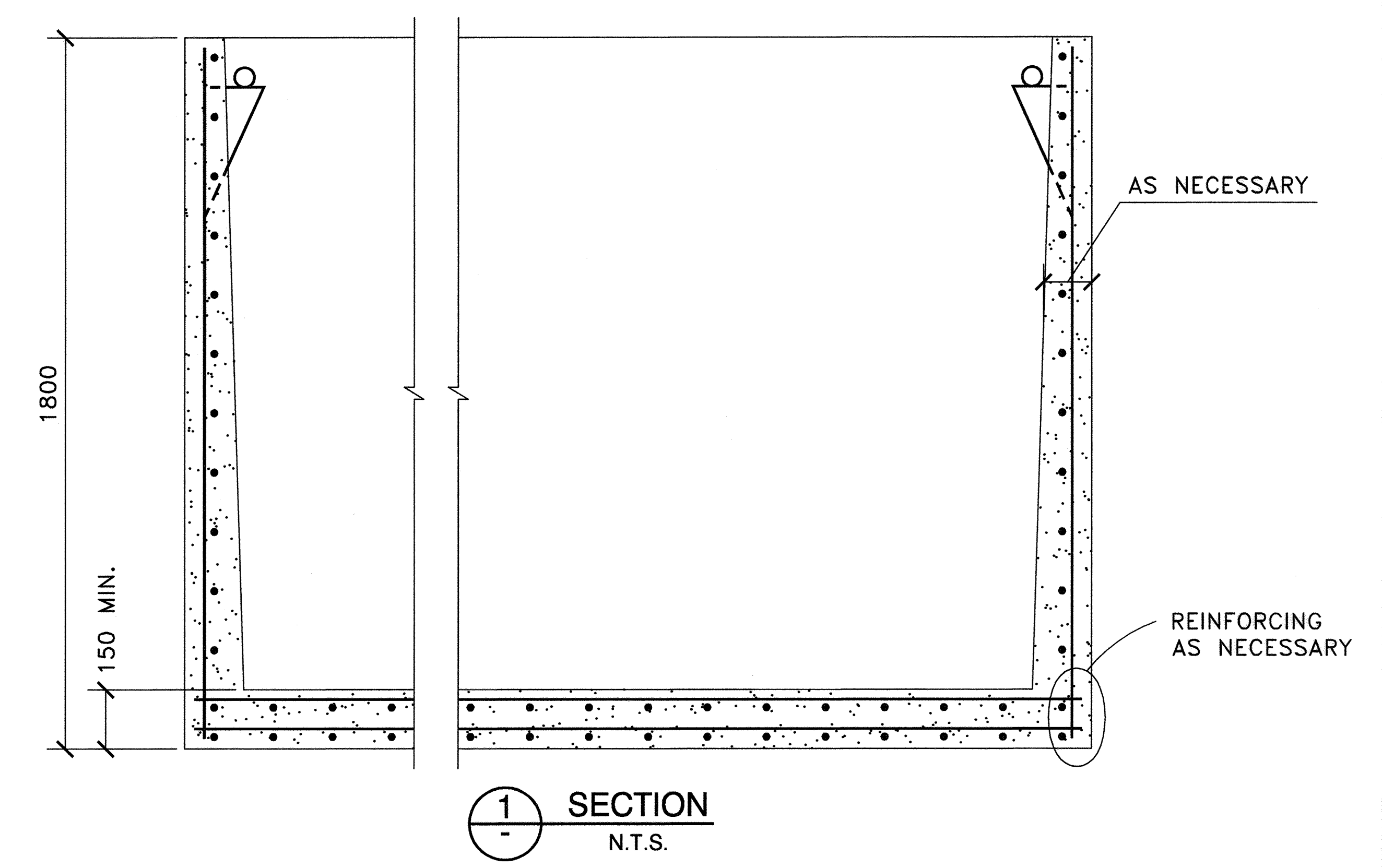

1 SECTION
N.T.S.

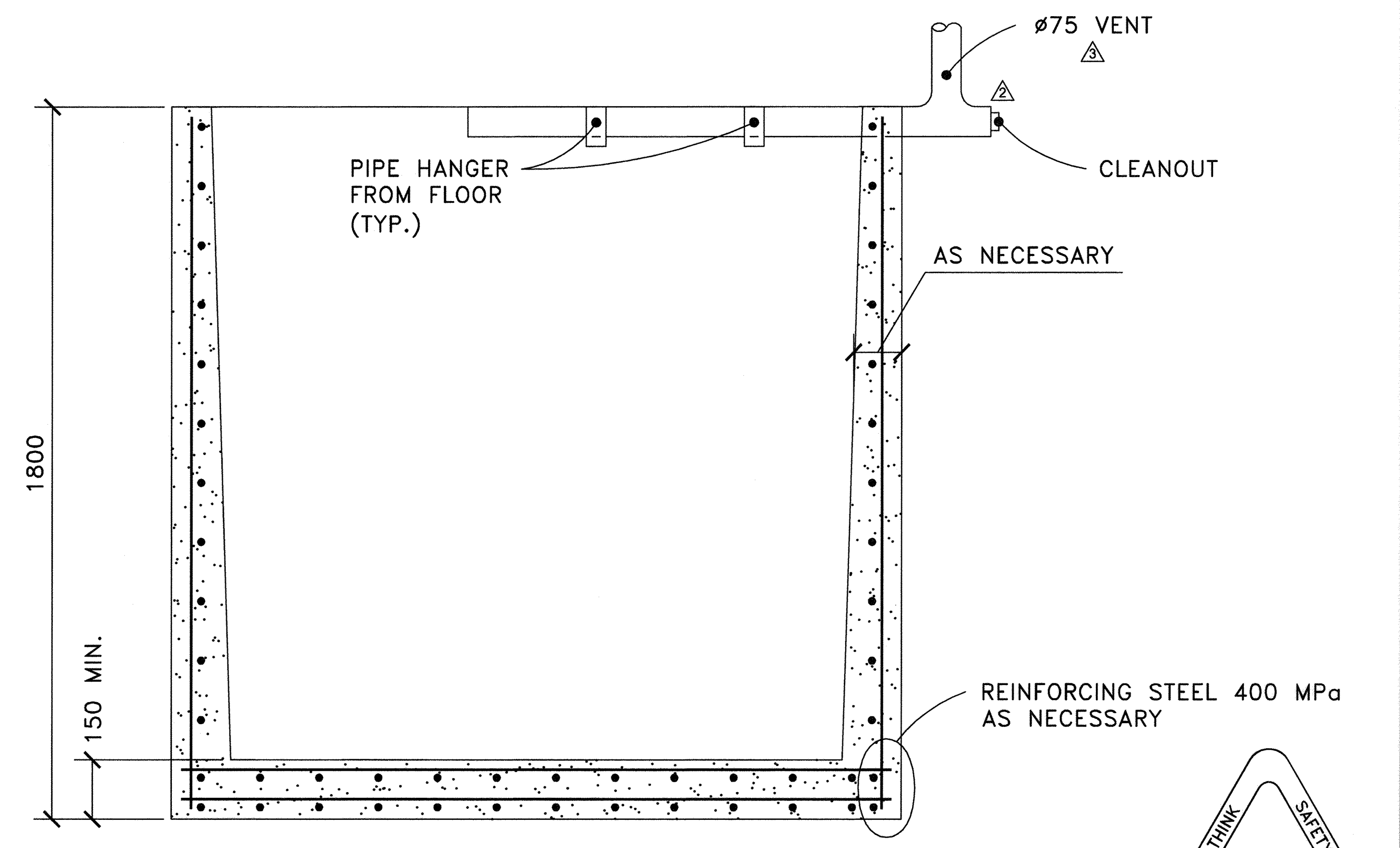

2 SECTION
N.T.S.

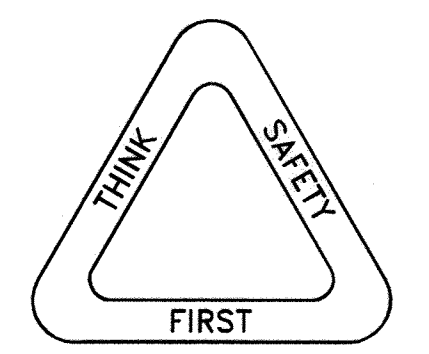

2013-01-18	REVISED SHEET SURROUND	AN	RECOMMENDED DIRECTOR HIGHWAY OPERATIONS
2012-02-07	ADDED TANK NOTES REVISED NOTES	AN	<i>[Signature]</i>
2011-06-27	2 RISERS ADDED, 1 REMOVED	AN	APPROVED EXECUTIVE DIRECTOR TECHNICAL STANDARDS BRANCH
2009-06-15	REDRAWN	SS	<i>[Signature]</i>
REV	DATE	REVISIONS	BY
DESIGNER	AN	CHECKER	DATE FEB 8/13

Alberta Transportation

**DOUBLE TOILET
TANK PLAN AND SECTIONS**

DEPARTMENT BAR CODE	DATE	SHEET	DRAWING
	2009-06-15	5 OF 21	CB6-4.6M5