

G:\ACADFILE\1515-16-192-2004-NORTH CENTRAL REGION\NC10\NC10-1 & 2.dwg-Oct. 27, 2004 2:57pm

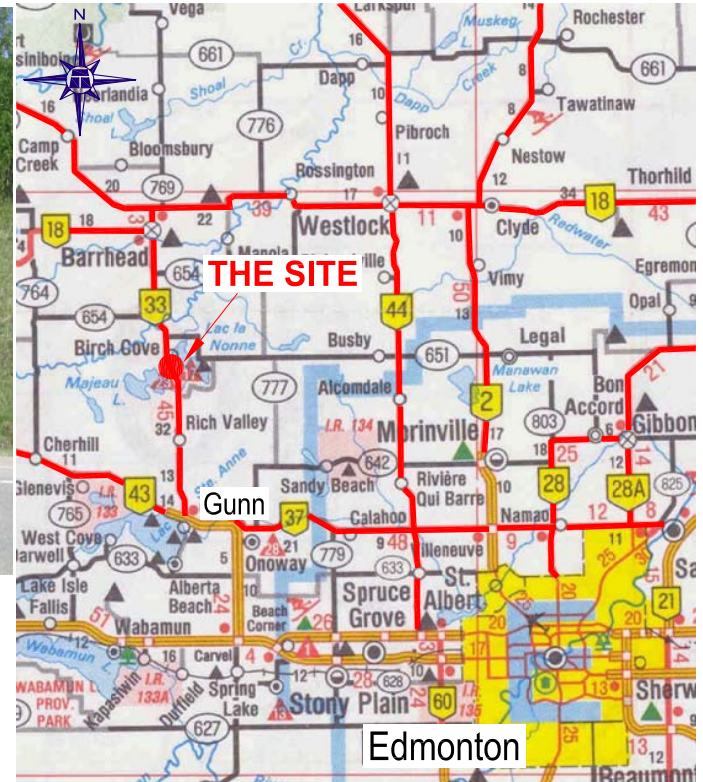

**SITE MAP**  
NOT TO SCALE

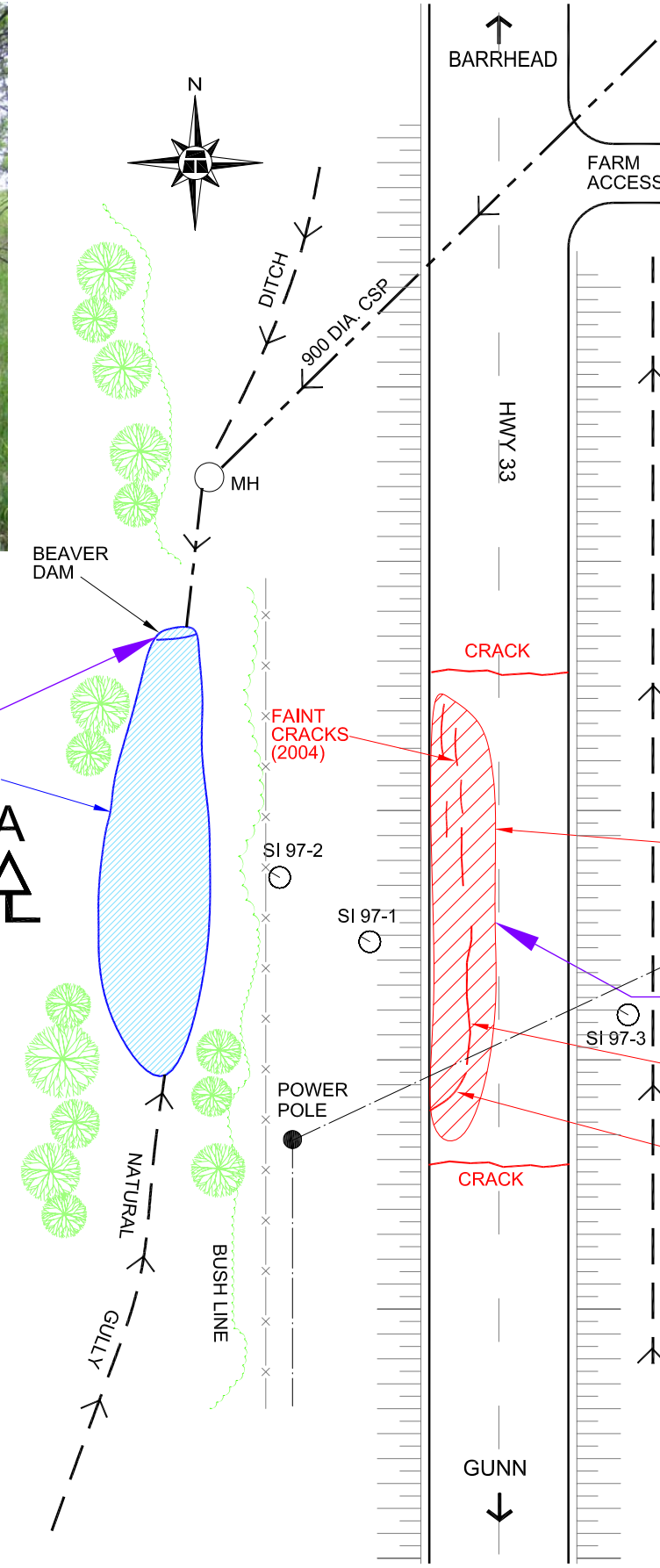

**LEGEND :**

⊙ SI CASING

**NOTES :**

1. FEATURE LOCATIONS ARE APPROXIMATE.
2. PREVIOUS OBSERVATIONS SHOWN IN BLACK
3. JUNE, 2004 OBSERVATIONS SHOWN IN RED

DRAWING WAS TAKEN FROM THURBER REPORT 15-16-168

THURBER PROJECT #15-16-192

ENGINEER	RVC
DRAWN	MNG
DATE	JULY 2004
APPROVED	
SCALE	N.T.S.

ALBERTA TRANSPORTATION

**SITE PLAN**

NORTH CENTRAL GEOHAZARD ASSESSMENTS

NC10 - HWY 33:04 km 25  
25 km NORTH OF GUNN  
SE-28-57-3-W5M



**THURBER**

**FIGURE NC10-1**

**SITE PLAN**  
N.T.S.

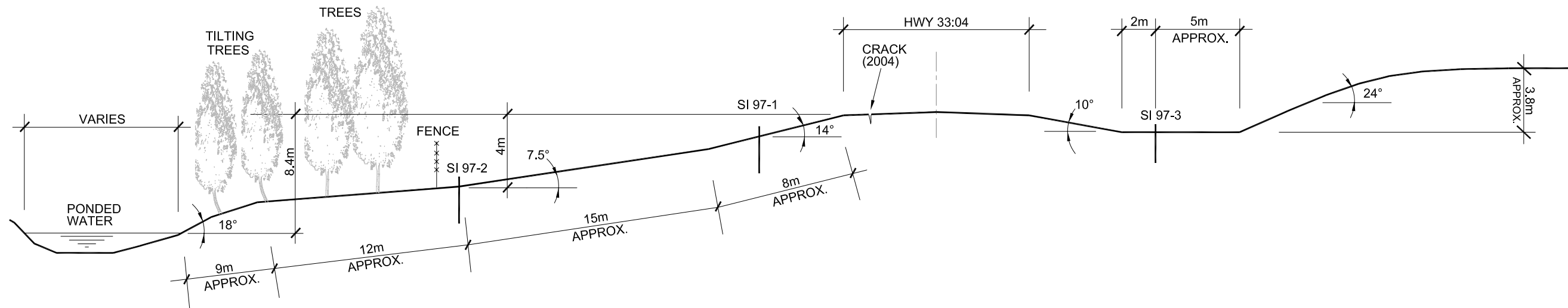

CROSS SECTION A-A'

ENGINEER	RVC
DRAWN	MNG
DATE	JULY 2004
APPROVED	
SCALE	N.T.S.

ALBERTA TRANSPORTATION	
<b>CROSS SECTION A-A'</b>	
NORTH CENTRAL GEOHAZARD ASSESSMENTS	NC10 - HWY 33:04 km 25 25 km NORTH OF GUNN SE-28-57-3-W5M



**THURBER**

**FIGURE NC10-2**