

GENERAL SITE LOCATION

SCALE: 1:3 000 000

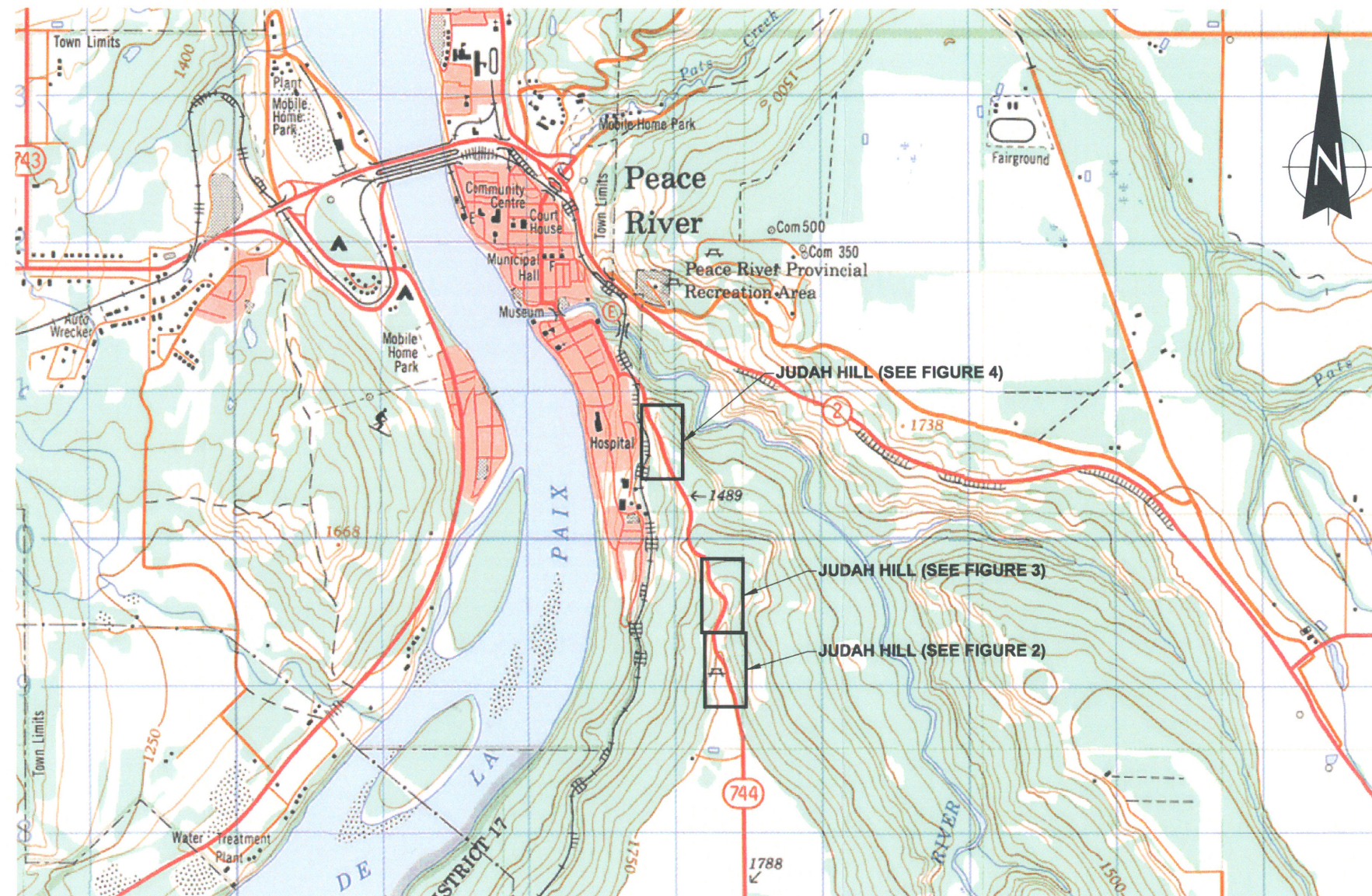
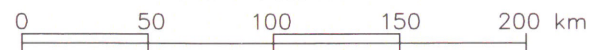

SITE LOCATION

SCALE 1:40 000



NOTES:

1 DRAWING COMPILED FROM MAP 84 C/3 TITLED "PEACE RIVER" (ED. 3, 1992) & INDEX MAP OF THE NATIONAL TOPOGRAPHIC SYSTEM" (PRAIRIE PROVINCES) PRODUCED BY THE CENTRE FOR TOPOGRAPHIC INFORMATION, NATURAL RESOURCES CANADA, 1998.

FIGURE 1A
PH12 HWY 744:04 JUDAH HILL
SITE LOCATION
PEACE REGION (PEACE RIVER / HIGH LEVEL)
 DATE : AUGUST 16, 2004
 FILE NO. 15-16-190-B5A





LEGEND:
SLOPE INDICATOR

PROPOSED SI AND DEPTH m



NOTES:
LOCATION DATA RECORDED USING HAND-HELD GPS RECIEVER.
ALL LOCATIONS ARE APPROXIMATE & ARE FOR ILLUSTRATIVE PURPOSES ONLY. GPS DATA RECORDED TO WGS84 COORDINATE SYSTEM.

FIGURE 2
PH12 HWY 744:04 JUDAH HILL
SITE PLAN
PEACE REGION (PEACE RIVER / HIGH LEVEL)
DATE : JUNE 17, 2004
FILE NO. 15-16-190-B8A



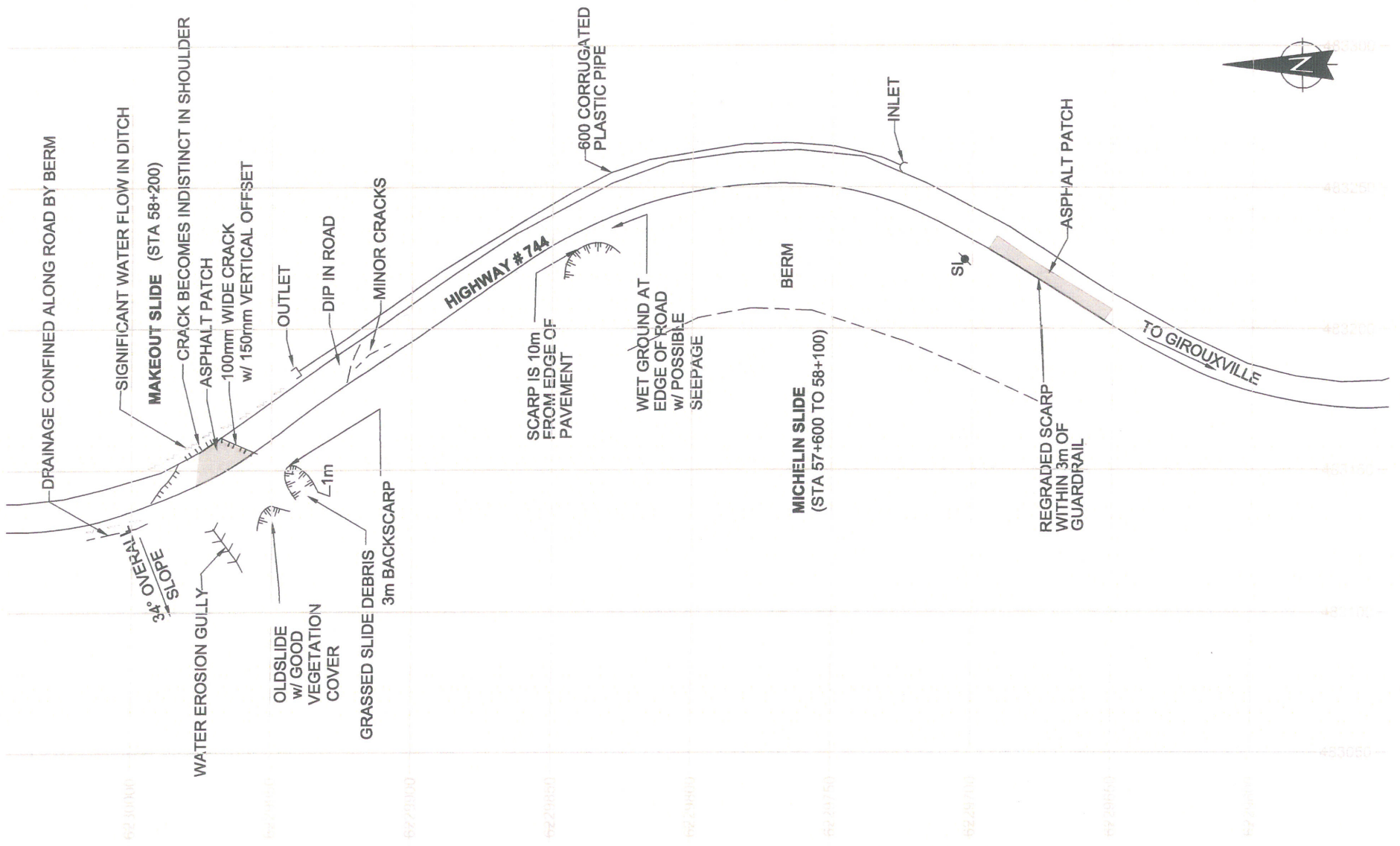

LEGEND:
 SLOPE INDICATOR ●

NOTES:
 LOCATION DATA RECORDED USING HAND-HELD GPS RECIEVER.
 ALL LOCATIONS ARE APPROXIMATE & ARE FOR ILLUSTRATIVE
 PURPOSES ONLY. GPS DATA RECORDED TO WGS84 COORDINATE
 SYSTEM.

FIGURE 3
PH12 HWY 744:04 JUDAH HILL
SITE PLAN
PEACE REGION (PEACE RIVER / HIGH LEVEL)
 DATE : JUNE 17, 2004
 FILE NO. 15-16-190-B7A



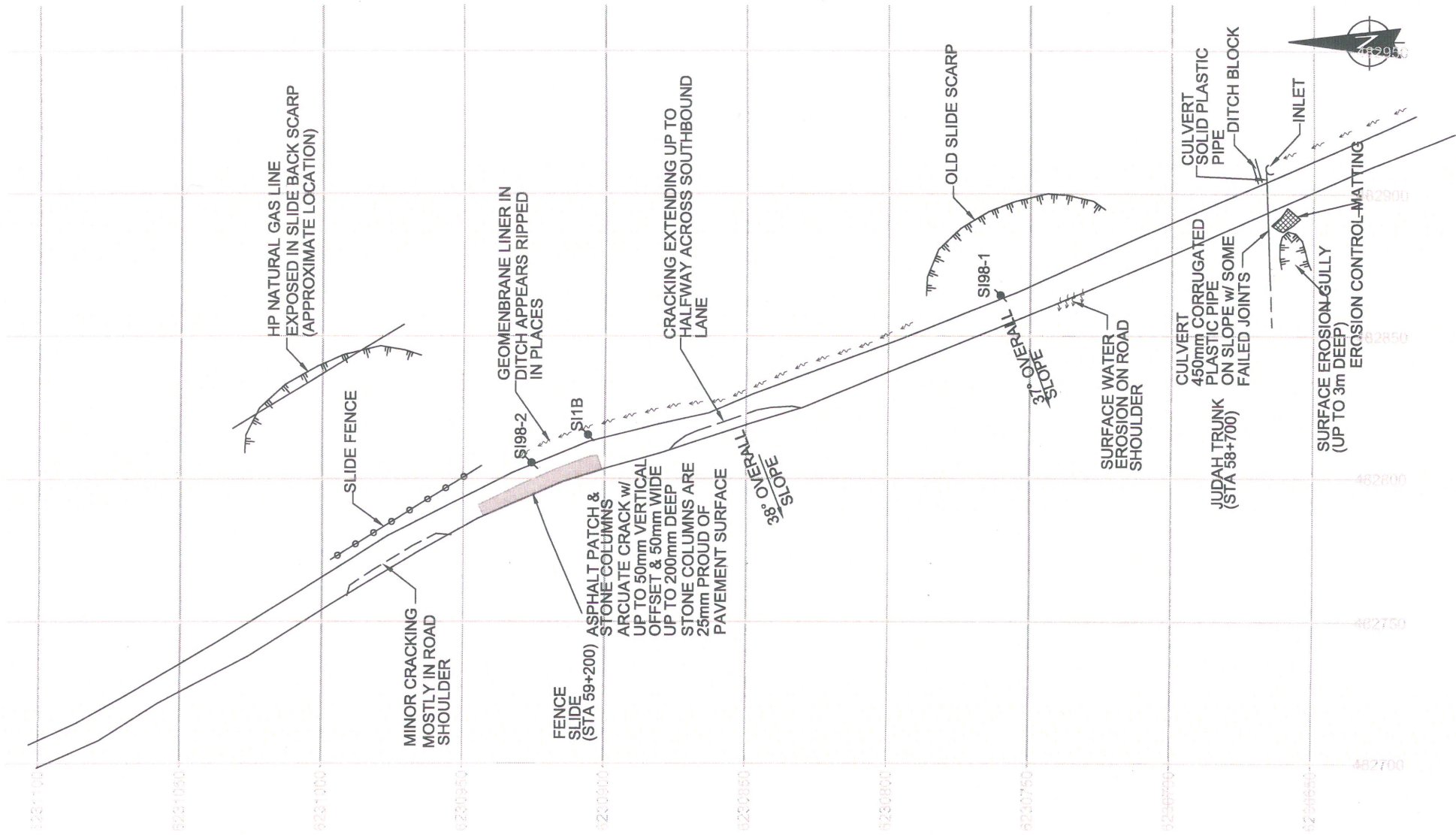

LEGEND:
 SLOPE INDICATOR

NOTES:
 LOCATION DATA RECORDED USING HAND-HELD GPS RECIEVER.
 ALL LOCATIONS ARE APPROXIMATE & ARE FOR ILLUSTRATIVE
 PURPOSES ONLY. GPS DATA RECORDED TO WGS84 COORDINATE
 SYSTEM.

FIGURE 4
PH12 HWY 744:04 JUDAH HILL
SITE PLAN
PEACE REGION (PEACE RIVER / HIGH LEVEL)
 DATE : JUNE 17, 2004
 FILE NO. 15-16-190-B6A

