

LEGEND	
1	EMPTY
2	"
3	30' PILING
4	3x10x16
5	4x12x16
6	30' PILING
7	40' "
8	3x10x26, 4x12x26
9	3x10x14
10	4x12x22
11	4x12x20
12	3x12x14
13	3x10x18
14	3x10x20
15	4x12x22, 4x12x24
16	12x14x20
17	50' PILING
18	45' "
19	12x14x22, 12x14x24
20	3x12x12
21	12x12x30, 30' PILING
22	3x10x22, 20 PILING
23	12x14x16
24	12x12x28, 30' PILING
25	3x8x20, 3x8x16
26	6x8x15
27	LOADING AREA
28	
29	20' PILING
30	45' "
31	30' "
32	8x10x28
33	6x8x28
34	3x10x16
35	
36	3x10x22, 3x12x22
37	3x12x18, 3x10x18
38	2x12x16, 3x12x16
39	3x10x12
40	4x6x18, 4x6x20
41	4x6x16, 12x14x15
42	10x10x16, 10x10x20, 4x6x14
43	3x8x14, 4x6x14
44	12x14x11½, 12x14x8½
45	8x20x28
46	25' PILING
47	35' "
48	3x10x16
49	3x10x20
50	30' PILING
51	12x14x20, 2x12x20
52	4x12x14 T&G
53	
54	3x10x22
55	4x12x12 T&G
56	4x12x16 T&G
57	3x12x20, 3x10x14
58	3x10x18
59	12x14x15
60	6x8x20
61	4x12x16
62	4x12x14 T&G
63	4x12x20, 6x12x20
64	6x16x20
65	12x14x18
66	3x10x20
67	3x10x18, 6x12x18, 25' PILING
68	6x12x16, 8x20x28, 25' PILING
69	6x12x12, 12x12x26, 12x14x26
70	12x14x30, 12x14x15
71	12x14x27, 12x12x24, 12x14x15, 12x12x20
72	35' PILING
73	
74	50' PILING
75	25' "
76	20' ", 6x12x20
77	EMPTY
78	12x14x27
79	12x12x18, 12x12x16, 6x12x14
80	40' PILING
81	25' "
82	25' "
83	30' "
84	25' "
85	35' "

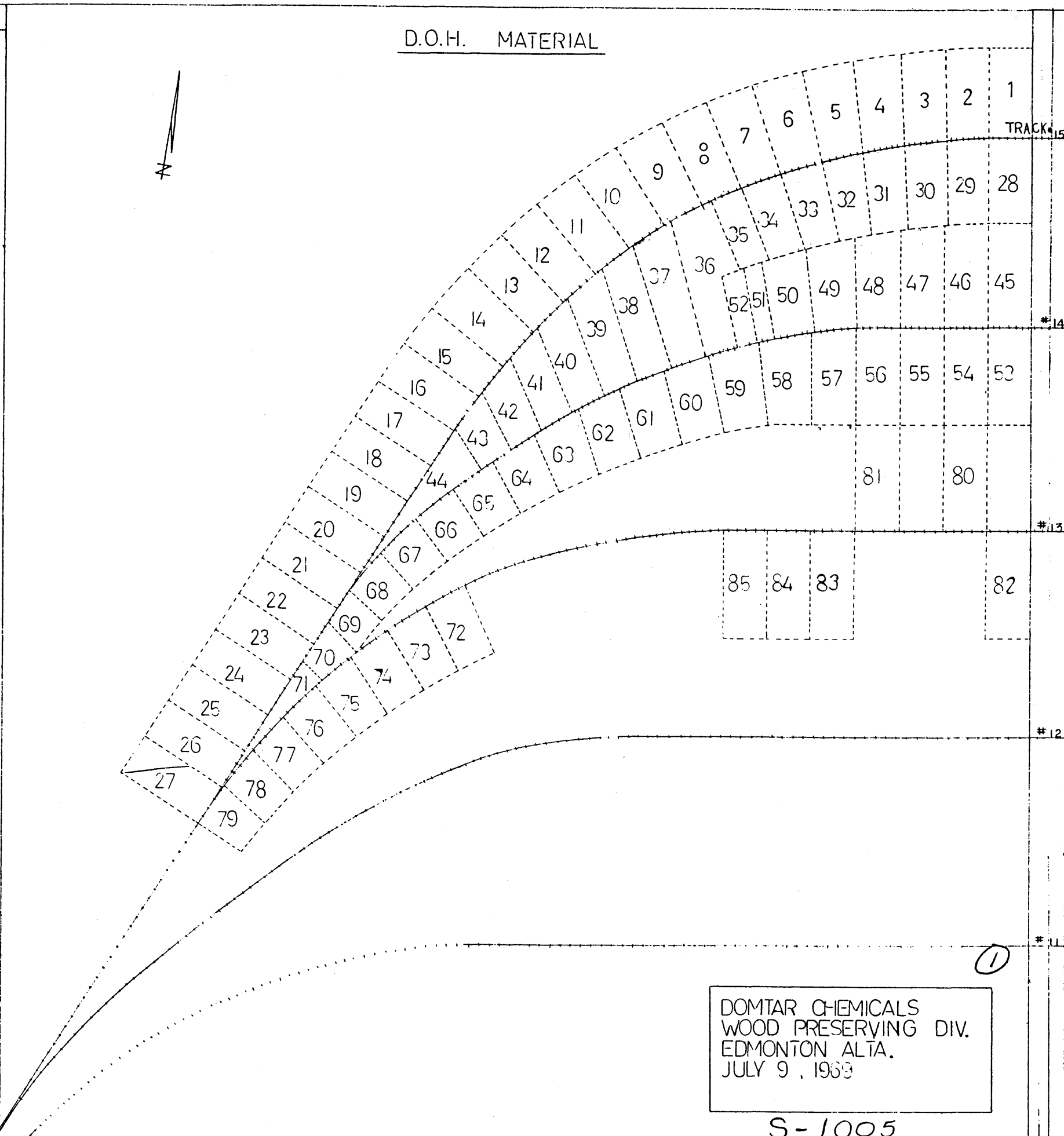

DOMTAR CHEMICALS
WOOD PRESERVING DIV.
EDMONTON ALTA.
JULY 9, 1969

S-1005

