

REINFORCING STEEL SHALL BE IN ACCORDANCE WITH C.S.A. STANDARD G 30.12 M BILLET - STEEL FOR CONCRETE REINFORCEMENT.

**BAR LIST: FOR UNSKEWED GIRDER.**

MARK	SIZE	NO.	TYPE	X	Y	LENGTH	MASS
G1001	10	270	C			430	91
G1002	10	103	B			1940	157
G1003	10	246	A			1550	299
G1004	10	8	STR.			600	4
G1501	15	12	STR.			12925	244
G1502	15	204	STR.			1435	460
G1503	15	10	E	450	450	900	14
G2001	20	4	D	1365		1965	19
G2002	20	6	D	1275		1875	26
G2003	20	4	STR.			1270	12
G2004	20	8	E	200	300	500	9
G2005	20	8	STR.			600	11
<b>TOTAL kg</b>							<b>1346</b>

* C1501	15	104	G			1200	196
** C1502	15	20	STR.			6450	203
* CG 1501	15	104	E	600	600	1200	196
* C6 1502	15	104	F			450	73
* C6 1503	15	2	STR.			12925	41
<b>TOTAL kg</b>							<b>709</b>

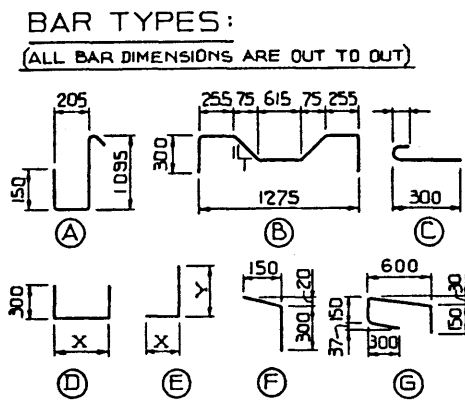

**NOTES:**  
 \* QUANTITY BASED ON 9 ANCHOR BOLT ASSEMBLIES. SEE BRIDGERAL LAYOUT FOR EACH BRIDGE FOR ACTUAL NUMBER OF ANCHOR BOLT ASSY.  
 \*\* LENGTH BASED ON 6500 mm JOINT SPACING. SEE CURB JOINT LAYOUT FOR EACH BRIDGE FOR ACTUAL JOINT SPACING.

**DESIGN DATA:**

- LOADING:**  
 LIVE LOAD - BRIDGE BRANCH MS-23  
 - 0.90 WHEEL LINE PER GIRDER.  
 DEAD LOAD - GIRDER = 1.25 t/m  
 - WEARING SURFACE AND SHEAR KEYS = 0.30 t/m
- FORCE IN PRESTRESSING STEEL:**  
 STRESS-RELIEVED LOW RELAXATION  
 INITIAL TENSIONING LOAD: 128.6 kN/STRAND  
 DESIGN LOAD AFTER LOSSES: 92.4 kN/STRAND (INTERIOR GIRDER)  
 128.6 kN/STRAND  
 100.7 kN/STRAND
- CONCRETE:**  
 28 DAY STRENGTH 35.0 MPa  
 RELEASE STRENGTH 28.0 MPa

**ESTIMATED CAMBER OF BOTTOM OF INTERIOR GIRDER LEG AT TIME OF RELEASE = 36 mm (STRESS RELIEVED STRANDS)**  
 \* THEORETICAL MASS OF ONE GIRDER IS 32.5 t (45.2 t WITH CURB)

WORK THIS DRAWING IN CONJUNCTION WITH DRAWING NO. S-1399

APPROVED: *J. A. S.* TRANSPORTATION BRIDGE BRANCH

DESIGNED: A.W. DRAWN BY: M.M.F. DATE: 77 12 19 CHECKED BY: *yesheet* DATE: *June 24/78* STREAM: LOCATION: HWY NO.: SCALE: FILE NO.: SHEET: 1 of 2 DWG NO.: S-1363

REVISIONS:

NO.	DATE	DESCRIPTION	BY
78 06 22		DEAD LOAD NOTE	J.A.S.
78 06 05		CURB WEIGHT	A.W.
78 05 10		STABILIZED TO LOW RELAXATION	R.G.Q.
78 02 23		NO. OF G2004 CHANGED IN BAR LIST	V.G.B.

DATE: **JAN 23/78**

**PRESTRESSED CONCRETE 26 m TYPE FM-1170 GIRDER**