

BAR LIST : FOR UNSKEWED GIRDER.

MARK	SIZE	NO.	TYPE	X	Y	LENGTH	MASS
G1001	10	354	C			430	119
G1002	10	135	B			1940	206
G1003	10	406	A			1750	558
G1004	10	8	STR.			600	4
G1501	15	18	STR.			11320	320
G1502	15	270	STR.			1435	608
G1503	15	10	E	450	450	900	14
G2001	20	4	D	1365		1965	19
G2002	20	10	D	1275		1875	44
G2003	20	4	STR.			1270	12
G2004	20	8	E	200	300	500	9
G2005	20	8	STR.			600	11
TOTAL kg						1924	

* C1501	15	135	G			1200	254
* C1502	15	40	STR.			4200	264
TOTAL kg						920	
* CG1501	15	135	E	600	600	1200	254
* CG1502	15	135	F			450	95
* CG1503	15	3	STR.			11320	53

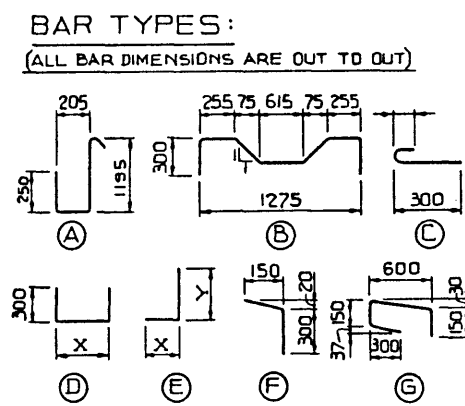

DESIGN DATA:

- LOADING:**
 - LIVE LOAD - BRIDGE BRANCH MS-23
 - DEAD LOAD - GIRDER = 0.90 WHEEL LINE PER GIRDER
 - WEARING SURFACE AND SHEAR KEYS = 0.3 t/m
- FORCE IN PRESTRESSING STEEL:**

	STRESS-RELIEVED	LOW RELAXATION
INITIAL TENSIONING LOAD	128.6 kN/STRAND	128.6 kN/STRAND
DESIGN LOAD AFTER LOSSES (INTERIOR GIRDER)	88.7 kN/STRAND	98.8 kN/STRAND
- CONCRETE:**

	STRESS RELIEVED	LOW RELAXATION
INT. 28 DAY STRENGTH	35.0 MPa	35.0 MPa
RELEASE STRENGTH	29.0 MPa	28.0 MPa
CURB 28 DAY STRENGTH	35.0 MPa	35.0 MPa
RELEASE STRENGTH	32.0 MPa	28.0 MPa
- ESTIMATED CAMBER OF BOTTOM OF INTERIOR GIRDER LEG AT TIME OF RELEASE = 67 mm (STRESS RELIEVED STRANDS)**
- THEORETICAL MASS OF ONE GIRDER IS 45.9 t (62.2 t WITH CURB)**

NOTES:

- QUANTITY BASED ON 11 ANCHOR BOLT ASSEMBLIES. SEE BRIDGERAIL LAYOUT FOR EACH BRIDGE FOR ACTUAL NUMBER OF ANCHOR BOLT ASSY.
- LENGTH BASED ON 4.250 JOINT SPACING. SEE CURB JOINT LAYOUT FOR EACH BRIDGE FOR ACTUAL JOINT SPACING.

WORK THIS DRAWING IN CONJUNCTION WITH DRAWING NO. S-1399

APPROVED: _____

CHIEF BRIDGE ENGINEER

DATE: _____

REVISIONS:

NO.	DATE	DESCRIPTION	BY

DESIGNED: B. D. N. DRAWN BY: M. M. F. DATE: 7/8 07 10 CHECKED BY: DATE: STREAM: LOCATION: HWY. NO. SCALE: FILE NO. SHEET: DWG. NO. S-1377

DIMENSIONS ARE GIVEN IN mm
MASS IN kg

Alberta TRANSPORTATION BRIDGE BRANCH **METRIC**

PRESTRESSED CONCRETE
34 m TYPE FM-1270
GIRDER