

BAR LIST									
MARK	SIZE	NO.	TYPE	X(mm)	Y(mm)	LENGTH(mm)	MASS(kg)		
G-1001	10	3	STR			13270	52		
G-1002	10	12	A			1080	10		
G-1003	10	13	B			630	67		
G-1004	10	59	C			2220	120		
G-1005	10	2	D	1000	300	1800	3		
G-1006	10	2	STR			13270	21		
G-1007	10	60	D	1125	300	1725	81		
G-2001	20	24	STR			3000	170		
S-1001	10	7	STR			13270	73		
S-1002	10	56	E			2268	100		

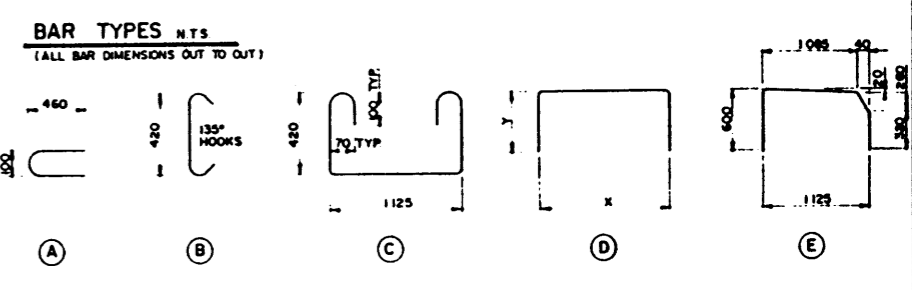

GENERAL NOTES

DESIGN

- CAN 3-56-M78
- LOADING
LIVE LOAD - BRIDGE BRANCH MS-230
ONE WHEEL LINE PER GIRDER
DEAD LOAD - GIRDER

MATERIALS

- CONCRETE IN SIDEWALK GIRDER SHALL BE MADE OF LIGHTWEIGHT COURSE AGGREGATE AND SAND FINES, AND BROWN CEMENT
- 28 DAY CONCRETE STRENGTH = 35 MPa
- RELEASE STRENGTH = 28 MPa
- UNIT WEIGHT OF SEMI-LIGHTWEIGHT CONCRETE = 1920 kg/m³
- PRESTRESSING STEEL SHALL BE 12.7mm # 7 WIRE STRESS-RELIEVED STRAND (F_{pu} = 1860 MPa) (F_{py} = 1350 MPa) (F_{pu} = 1860 MPa) (F_{py} = 1350 MPa) MAY BE SUBSTITUTED FOR STRESS-RELIEVED STRAND ON A ONE FOR ONE BASIS AT THE SAME INITIAL STRESS THE ENGINEER SHALL BE NOTIFIED IF SUBSTITUTION IS MADE.
- GROUT SHALL BE MADE WITH BROWN CEMENT TO MATCH GIRDER CONCRETE

FABRICATION

- GIRDERS SHALL CONFORM TO THE REQUIREMENTS OF THE ALBERTA BRIDGE BRANCH SPECIFICATION FOR THE MANUFACTURE OF PRESTRESSED CONCRETE BRIDGE UNITS.
- FORCE IN PRESTRESSING STEEL:
INITIAL TENSIONING LOAD = 28.6 kN/STRAND
DESIGN LOAD AFTER LOSSES = 36.1 kN/STRAND
- ALL GALVANIZING SHALL CONFORM TO ASTM SPEC. A153.
- BEND OR SHIFT REINFORCING WHERE REQUIRED TO CLEAR GIRDER CONNECTORS, AND LIFTING HOOK ASSEMBLIES. STIRRUP SPACING IS TO BE MAINTAINED.

ERECTOR

- ANY FREE SPACE BETWEEN CONNECTORS SHALL BE FILLED WITH WASHERS
- CALCULATED MASS OF ONE SIDEWALK GIRDER UNIT IS 19.88 tonnes

THE ASSOCIATION OF PROFESSIONAL ENGINEERS OF ALBERTA		PERMITS NUMBER P 220		DOLTER PARISH TRIMBLE LTD.	
NO.	DATE	DESCRIPTION	BY	DATE	BY
1	JULY 30, 1981	ANCHOR BOLT PATTERN	J.R.C.	APRIL, 1981	109-6-51
REVISIONS					

Bolter Parish Trimble Ltd.
CONSULTING ENGINEERS

DATE: APRIL, 1981
SPT DWG: 109-6-51
DWN. BY: L.S.K.
DESIGNED BY: S.D.S.

ALBERTA TRANSPORTATION
BRIDGE AND STRUCTURAL ENGINEERING BRANCH

KANANASKIS COUNTRY BRIDGES

SIDEWALK GIRDER
11 m TYPE SM 510-SINGLE SPAN

SHT. NO. OF FILE NO. HWY. STA. DWG. NO. S-1456

