

**BENCH MARK TABLET**

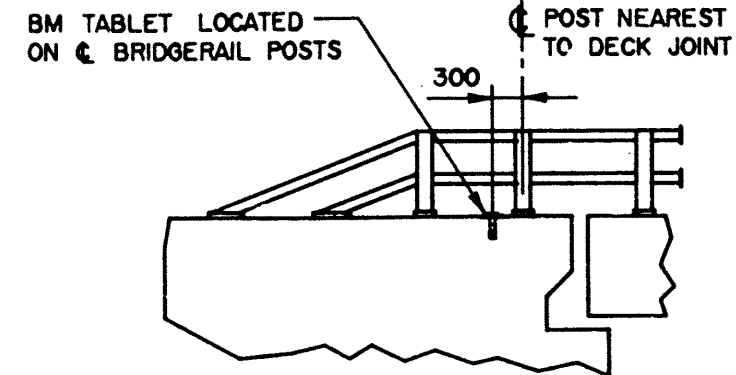

**WINGWALLS PARALLEL TO ROAD**

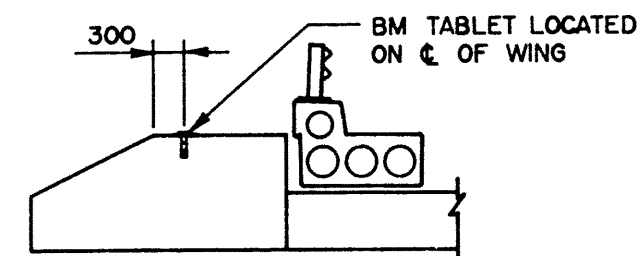

**WINGWALLS PARALLEL TO STREAM**

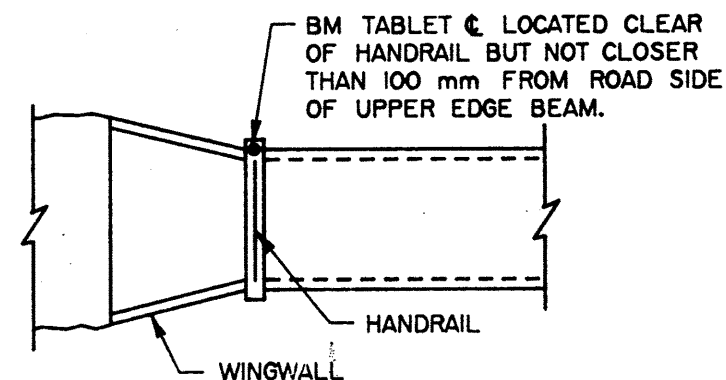

**CONCRETE ARCH AND BOX CULVERTS**

**GENERAL NOTES**

- DIMENSIONS ARE GIVEN IN mm. DETAILS ARE NOT TO SCALE.
- ONE BRONZE BM TABLET WILL BE SUPPLIED BY THE DEPARTMENT FOR EACH STRUCTURE. IT SHALL BE INSTALLED BY THE CONTRACTOR.
- BM TABLET SHALL BE PLACED FOR EASY ACCESS WITH SURVEY ROD.
- BM TABLET SHALL GENERALLY BE PLACED ON THE NW CORNER OF THE BRIDGE AS PRESCRIBED ON THE BRIDGE DRAWINGS.
- BM TABLET SHALL BE PLACED ONLY IN SUBSTRUCTURE ELEMENTS NOT SUBJECT TO SETTLEMENT, i.e. ABUTMENTS SUPPORTED ON PILES OR FIRM BEDROCK.
- BM ELEVATION SHALL BE DETERMINED BY THE DEPARTMENT AFTER INSTALLATION AND SHALL BE SHOWN ON THE "AS CONSTRUCTED" GENERAL LAYOUT DRAWING.

**SUPERSEDED**  
 BY 5-1478-REV 2  
 ON SHEET 3

DRAFTING STANDARDS PAGE: 3.5

|          |       |                         |                    |   |          |      |         |
|----------|-------|-------------------------|--------------------|---|----------|------|---------|
|          |       |                         |                    | <b>Alberta</b> TRANSPORTATION AND UTILITIES<br>BRIDGE ENGINEERING BRANCH  |          |      |         |
|          |       |                         |                    | <b>STANDARD</b><br><b>BRIDGE BENCH MARK TABLET</b><br><b>INSTALLATION</b> |          |      |         |
| 90-03-01 |       | DFT STD PAGE NO CHANGED |                    | VGB   |          |      |         |
| NO       | DATE  | REVISIONS               |                    | BY  |          |      |         |
| DESIGNED | DRAWN | DATE                    | APPROVED           | SIGNATURE   | DATE     | PAGE | DRAWING |
| DHO      | WS    | 87-09-02                | EXECUTIVE DIRECTOR | <i>[Signature]</i>  | 87-09-02 | 13.7 | S-1478  |