

(A) DECK SECTION
1/4" = 1'-0

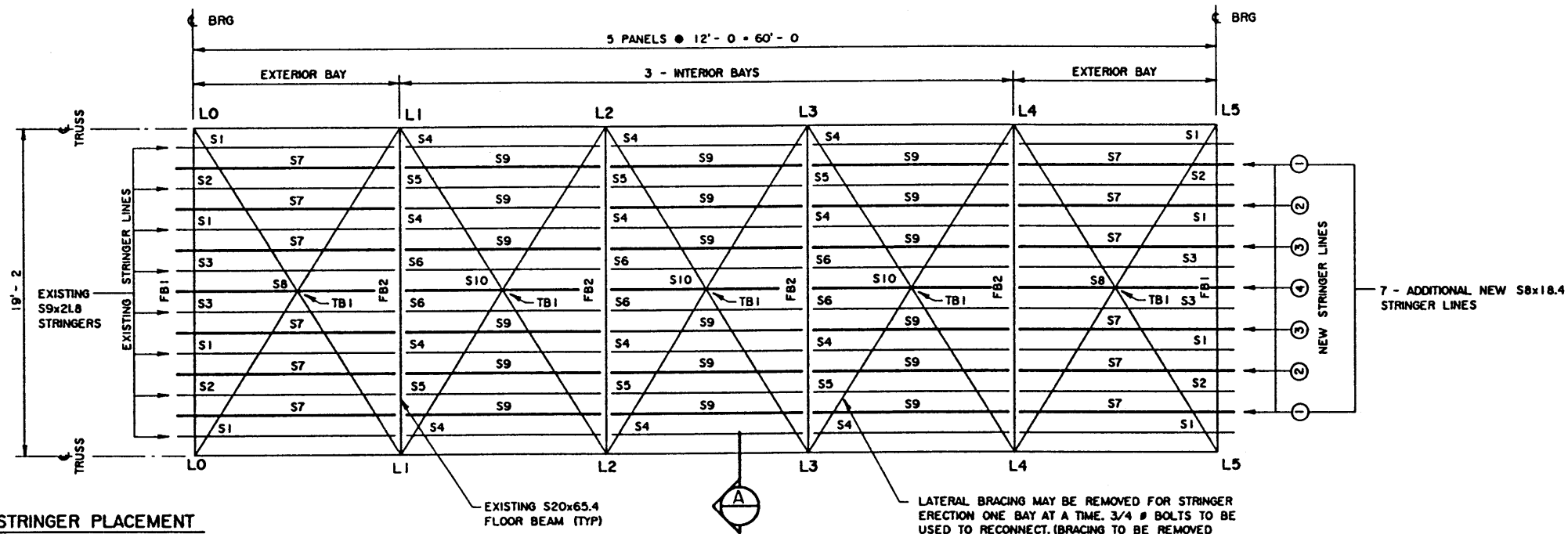

PLAN - FLOOR SYSTEM
1/4" = 1'-0

- STRINGER PLACEMENT**
- EXISTING STRINGERS S1 TO S6 SHALL REMAIN IN PLACE.
- REMOVE EXISTING HANGERS FROM S3 AND S6 STRINGER WEBS AND PLUG HOLES WITH 3/4" #2 LG FIELD BOLTS.
 - NEW ADDITIONAL STRINGERS REQUIRED ON LINES ① ② ③ AND ④ AS SHOWN ON (A) DECK SECTION AND "PLAN - FLOOR SYSTEM" AND DETAILED ON DRAWING S-1482.

LATERAL BRACING MAY BE REMOVED FOR STRINGER ERECTION ONE BAY AT A TIME. 3/4" # BOLTS TO BE USED TO RECONNECT. (BRACING TO BE REMOVED ONLY IF NECESSARY)

- GENERAL NOTES**
- NOTE RE A24 TRUSSES AS OF DECEMBER 1987: TRUSSES A24-17 AND A24-39 WERE FABRICATED WITH 7 LINES OF S10x28 STRINGERS; ALL OTHER A24 TRUSSES HAD 8 LINES OF S9x21.8 STRINGERS.
 - DRAWINGS USED (OR TO BE USED) FOR STRENGTHENING ARE:

A24-05	12257-P	TO	12261-P
A24-15	12094-P	TO	12098-P
A24-17	12509-P	TO	12513-P
A24-39	12509-P	TO	12513-P
 - ALL OTHERS: CREATE A SITE SPECIFIC BRIDGE LAYOUT DRAWING AND USE REMAINING DRAWINGS AS PER INDEX ON DRAWING S-1480 (WITH STRINGER INSERTIONS) OR DRAWING S-1473 (WITH STRINGER RESPACING).
 - ALL DIMENSIONS ARE GIVEN IN IMPERIAL UNITS.
 - BRIDGE ENGINEERING BRANCH INVENTORY RATING FOR THE STRENGTHENED TRUSS AND FLOOR SYSTEM (IN TONNES) (FOR 7" TIMBER DECK):

	H TRUCK	H5 TRUCK	CS TRUCK
STRINGERS	30.5	54.9	81.3
FLOORBEAMS	27.1	48.8	72.4
TRUSS MEMBERS (L2L3)	37.7	41.3	65.0
 - ESTIMATED STEEL WEIGHT OF ONE STRENGTHENED SPAN: 21.3 TONNES.

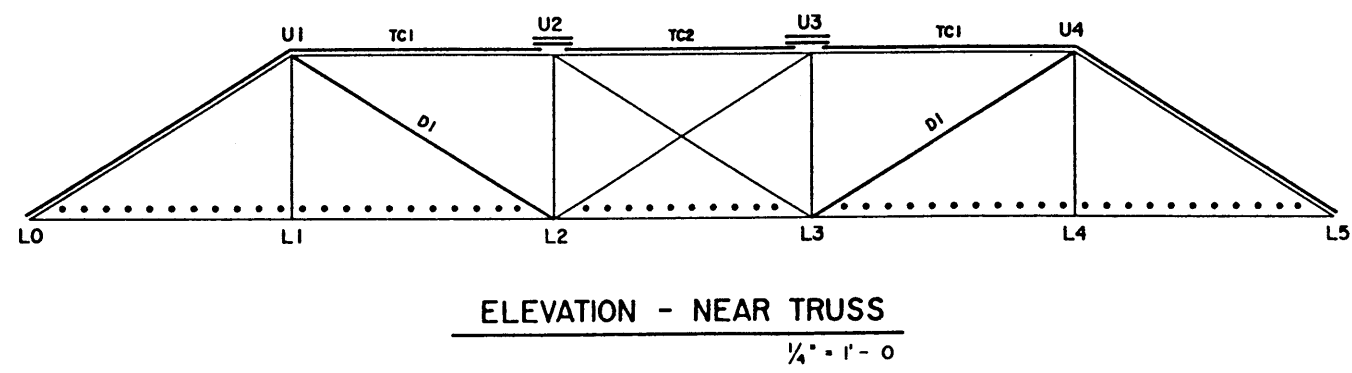

ELEVATION - NEAR TRUSS
1/4" = 1'-0

LEGEND

—	EXISTING MEMBERS
—	NEW STRENGTHENING MEMBERS
.....	POST-TENSIONING DYWIDAG BAR

INDEX

5 of 5	MATERIAL LIST AND NOTES	S-1484
4 of 5	TOP CHORD	S-1483
3 of 5	ADDITIONAL STRINGERS AND REPLACEMENT DIAGONALS	S-1482
2 of 5	BOTTOM CHORD POST-TENSIONING	S-1481
1 of 5	TRUSS LAYOUT	S-1480
SHEET	DESCRIPTION	DRAWING

DESIGNED D H O				DRAWN W S				DATE 87-12-15				CHECKED				DATE				STREAM				LOCATION				HIGHWAY				FILE				SHEET 1 of 5				DRAWING S-1480			
<p>APPROVED</p> <p>EXECUTIVE DIRECTOR BRIDGE ENGINEERING</p> <p>DATE: 87-12-15</p>																																											
<p>Alberta TRANSPORTATION AND UTILITIES BRIDGE ENGINEERING BRANCH</p> <p>A24 PONY TRUSS STRENGTHENING WITH STRINGER INSERTIONS TRUSS LAYOUT</p>																																											