

**BAR LIST: — INTERIOR SKEWED GIRDER — EXTRA BARS FOR 2 ENDS**

MARK	SIZE	TYPE	X	Y	LENGTH	15° SKEW		30° SKEW		45° SKEW	
						NO	MASS	NO	MASS	NO	MASS
G1013	10	B	1 165		2 260	6	11	2	4	2	4
G1014	10	B	1 300		2 390		6	11	2	2	4
G1015	10	B	1 590		2 680					6	13
G1016	10	A	1 165		1 765	6	8	2	3	2	3
G1017	10	A	1 300		1 900		6	9	2	2	3
G1018	10	A	1 590		2 190					6	10
G1019	10	D			1 280	2	2			6	6
G1020	10	C	1 000		1 520	2	2	4	5	8	9
G1021	10	E			1 585	2	2		3		
G1022	10	E			1 705			2	3		
G1023	10	E			1 965					2	3
G1025	10	C	120		670	14	7	22	12	26	14
<b>TOTAL</b>						kg	32	47	69		

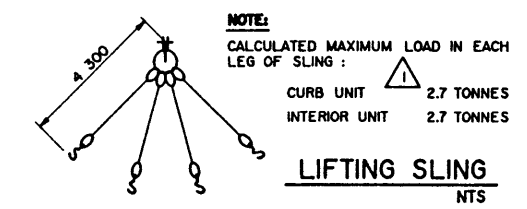
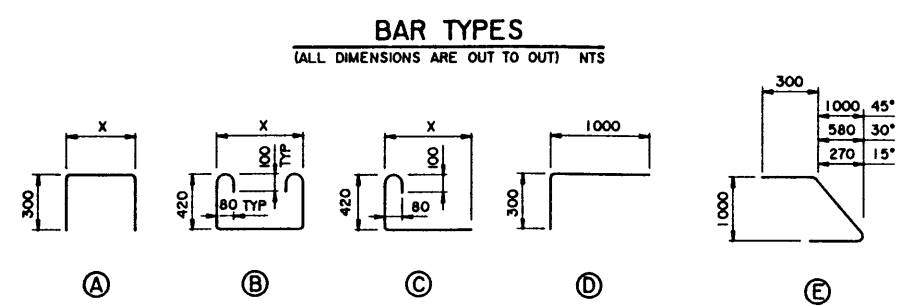

REV	DATE	REVISIONS	CHECKED	DATE	BY
94-04-05		LIFTING HOOK POCKET SHAPE REVISED			
92-01-10		CURB UNIT SLING LOAD	DHQ		
DESIGNED	LEA	DRAWN	VMV	DATE	90-07-02
CHECKED	TJS	DATE	90-08-23		

**Albera TRANSPORTATION AND UTILITIES**  
BRIDGE ENGINEERING BRANCH

**PRESTRESSED CONCRETE**  
8 m TYPE SC-510  
INTERIOR AND CURB GIRDER LAYOUTS

ORIGINAL DRAWING APPROVED BY  
N. BOYD  
EXECUTIVE DIRECTOR  
BRIDGE ENGINEERING  
AUG 23, 1990

DESIGNED	DRAWN	DATE	CHECKED	DATE	STREAM	LOCATION	HIGHWAY	FILE	SHEET	DRAWING
LEA	VMV	90-07-02	TJS	90-08-23					3 of 4	S-1540