

BAR LIST: FOR SQUARE GIRDER							
MARK	SIZE	NO	TYPE	X	Y	LENGTH	MASS
C1003	10	3	STR			9 900	23
C1008	10	2	A	310	600	1 510	2
C1501	15	48	E			1 455	109
G1006	10	6	D			1 020	5
G1010	10	2	STR			9 900	16
G1011	10	2	STR			9 800	15
G1026	10	44	A	725	300	1 325	46
G1027	10	57	B	725		1 820	81
G1028	10	2	A	600	300	1 200	2
G1029	10	6	STR			700	3
G1501	15	57	C			1 140	102
G2501	25	2	A	9 850	350	10 550	83

TOTAL kg : 487

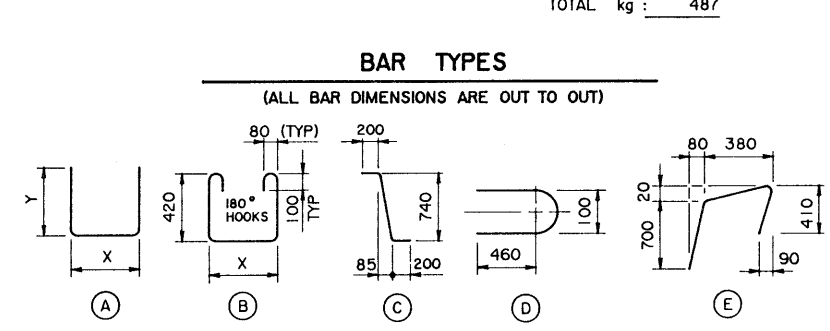

- GENERAL NOTES**
- ALL DRAWING REFERENCES ARE TO CURRENT DRAWINGS.
 - DESIGN**
 - CAN/CSA-S6-88 SPECIFICATIONS EXCEPT AS MODIFIED BELOW:
 - ALLOWABLE TENSION AT MIDSPAN IS 40% OF MODULUS OF RUPTURE (SEVERE EXPOSURE CONDITIONS).
 - NO TENSION ALLOWED IN DECK SURFACE.
 - **LOADING:**
 - LIVE LOAD - CAN/CSA-S6-88; CS-750
 - 0.8 WHEEL LINES PER GIRDER
 - DEAD LOAD - GIRDER = 0.86 t/m
 - WEARING SURFACE = 0.09 t/m
 - MATERIALS**
 - CONCRETE SHALL CONTAIN SILICA FUME AND BE MADE OF LIGHTWEIGHT COARSE AGGREGATE SAND FINES. UNIT WEIGHT OF SEMI-LIGHT WEIGHT CONCRETE SHALL BE 1920 kg/m³.
 - 28 DAY CONCRETE STRENGTH—35 MPa
 - RELEASE STRENGTH — 28 MPa
 - PRESTRESSING STEEL SHALL BE 13# 7 WIRE LOW RELAXATION STRAND (f_{pu} = 1860 MPa).
 - REINFORCING STEEL SHALL BE GRADE 400W (YIELD STRENGTH OF GRADE 300 USED IN DESIGN TO ALLOW TACK WELDING OF SHEAR REINFORCEMENT).
 - FABRICATION**
 - GIRDERS SHALL CONFORM TO THE CURRENT REQUIREMENTS OF THE BRIDGE MATERIALS SPECIFICATION FOR THE MANUFACTURE OF PRESTRESSED CONCRETE BRIDGE UNITS (SPEC B190).
 - FORCE IN PRESTRESSING STEEL:
 - INITIAL TENSIONING LOAD = 129 kN/STRAND
 - DESIGN LOAD AFTER LOSSES = 112 kN/STRAND
 - CURB SHALL BE CAST MONOLITHICALLY WITH GIRDER.
 - ANCHOR BOLT ASSEMBLIES SHALL BE CAST IN GIRDER AT SPACINGS SHOWN ON DRAWING S-1543.
 - ALL GALVANIZING SHALL CONFORM TO ASTM SPEC A123 OR A153 AS APPLICABLE.
 - BEND OR SHIFT REINFORCING WHERE REQUIRED TO CLEAR GIRDER CONNECTORS AND LIFTING HOOK ASSEMBLIES. STIRRUP SPACING SHALL BE MAINTAINED.
 - ERECTION**
 - ANY FREE SPACE BETWEEN CONNECTORS SHALL BE FILLED WITH DROP-IN WASHERS.
 - CALCULATED MASS OF ONE GIRDER IS 9.0 t.
 - WORK THESE DRAWINGS TOGETHER : S-1541, S-1542 AND S-1543.

BY S-1542 rev. 2 94-04-05

SUPERSEDED

APPROVED				Alberta TRANSPORTATION AND UTILITIES BRIDGE ENGINEERING BRANCH			
EXECUTIVE DIRECTOR BRIDGE ENGINEERING				PRESTRESSED CONCRETE 10 m TYPE SC-510 CURB GIRDER			
REV	DATE	REVISIONS	CHECKED	DATE	BY	DATE	DATE
92-01-10		ANCHOR BOLT PROJ., CONC MATERIALS NOTE	D.H.R.			AUG 23, 1990	
DESIGNED	DRAWN	DATE	CHECKED	DATE	STREAM	LOCATION	HIGHWAY
LEA	VMV	90-07-02	T.J.S.L.	90-08-23			
FILE	SHEET	DRAWING					
	2 of 4	S-1542					