

NOTE:
 • SHIFT SLAB BARS TO CLEAR LIFTING HOOK POCKETS WHERE REQUIRED.
 • SLAB BARS NOT DIMENSIONED ARE TIGHT AGAINST ADJACENT STIRRUP.
 • USE THIS ϵ DIMENSION TO IDENTIFY THIS STIRRUP (*) IN THE STIRRUP SERIES FOR A SQUARE ENDED UNIT.

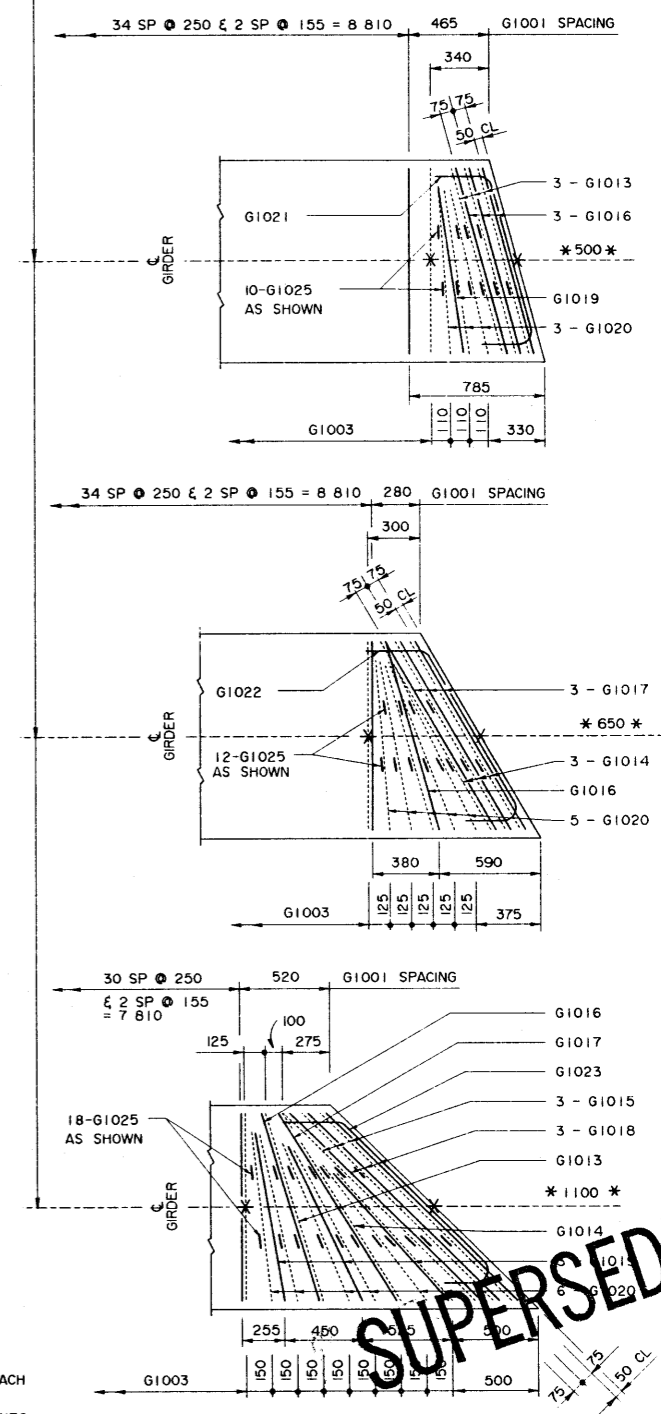

INTERIOR GIRDER REINFORCING BARS
 • SKEWS ARE SHOWN RIGHT HAND FORWARD.
 • LEFT HAND SKEWS ARE OPPOSITE AS SHOWN.

Alberta TRANSPORTATION AND UTILITIES
 BRIDGE ENGINEERING BRANCH

PRESTRESSED CONCRETE
 10.06 m TYPE SC-510
 INTERIOR AND CURB GIRDER LAYOUTS

APPROVED _____
 EXECUTIVE DIRECTOR
 BRIDGE ENGINEERING

DATE _____

DESIGNED: LEA DRAWN: VMV DATE: 93-08-23 CHECKED: SBD DATE: _____

STREAM: _____ LOCATION: _____ HIGHWAY: _____ FILE: _____ SHEET: 3 of 4 DRAWING: S-1570

BAR LIST: — INTERIOR SKEWED GIRDER — EXTRA BARS FOR 2 ENDS

MARK	SIZE	TYPE	X	Y	LENGTH	15° SKEW		30° SKEW		45° SKEW	
						NO	MASS	NO	MASS	NO	MASS
G1013	10	B	1 165		2 260	6	11			2	4
G1014	10	B	1 300		2 390			6	11	2	4
G1015	10	B	1 590		2 680					6	13
G1016	10	A	1 165		1 765	6	8	2	3	2	3
G1017	10	A	1 300		1 900			6	9	2	3
G1018	10	A	1 590		2 190					6	10
G1019	10	D			1 280	2	2			6	6
G1020	10	C	1 000		1 520	6	7	10	12	12	14
G1021	10	E			1 585	2	2				
G1022	10	E			1 705			2	3		
G1023	10	E			1 965					2	3
G1025	10	C	120		670	20	11	24	13	36	19
TOTAL kg							41		51		79

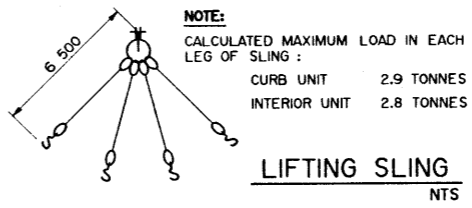
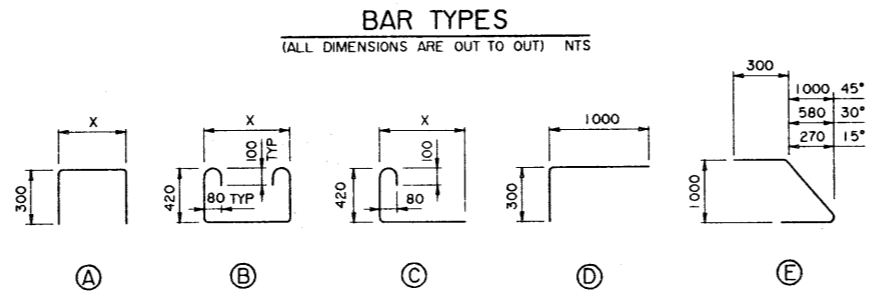

SUPERSEDED

AT & U - RECORDS SECTION