

NOTE:  
FOR SKEWS > 30°  
CONSULTANT TO DETERMINE  
DIAPHRAGM ORIENTATION AND  
LAYOUT

**DIAPHRAGM LAYOUT FOR SKEWS ≤ 30°**  
1:200

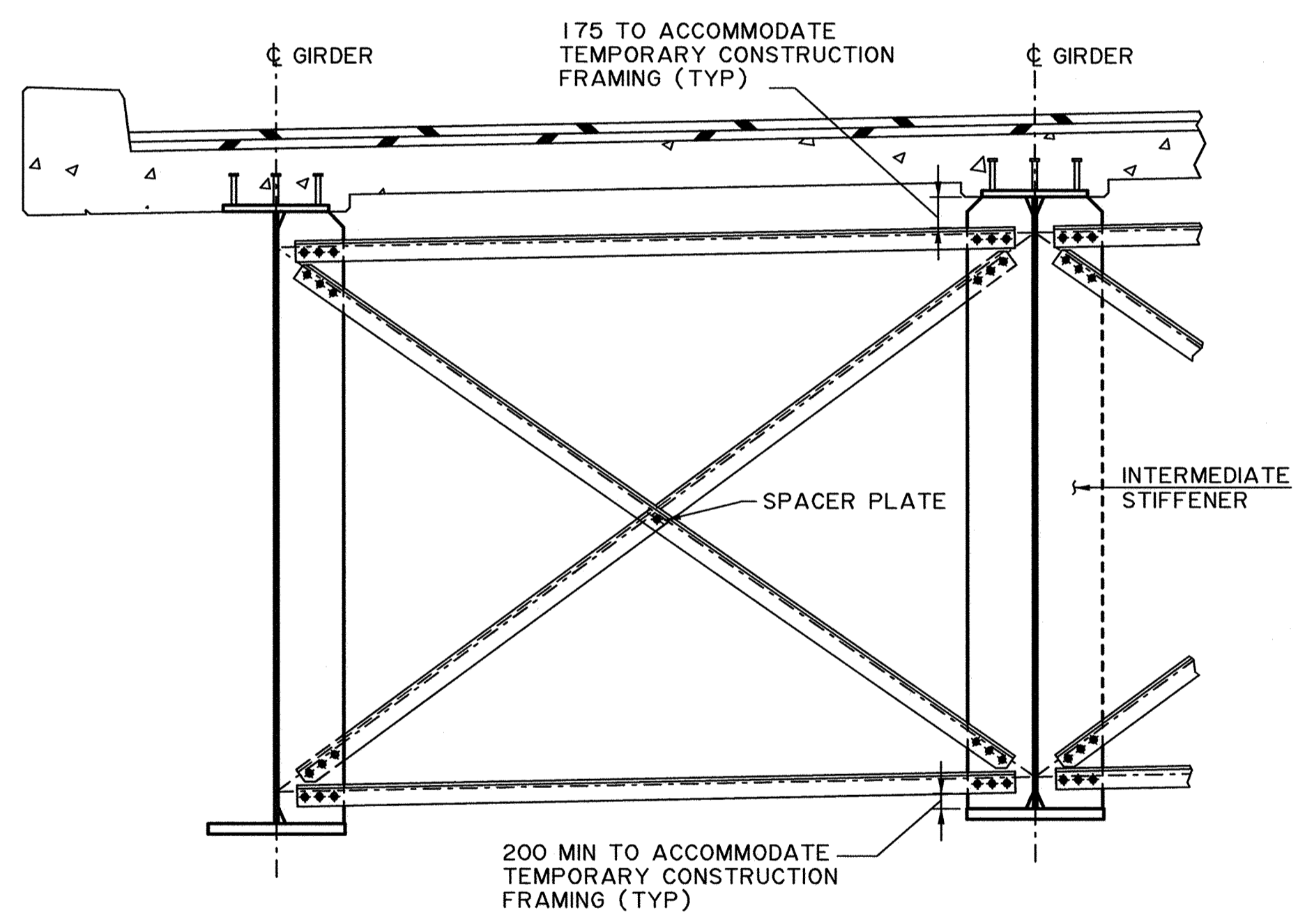

**CROSS-BRACING DETAILS  
AT INTERMEDIATE DIAPHRAGM**

X-BRACING SHOWN  
K-BRACING ALSO ACCEPTABLE  
1:25

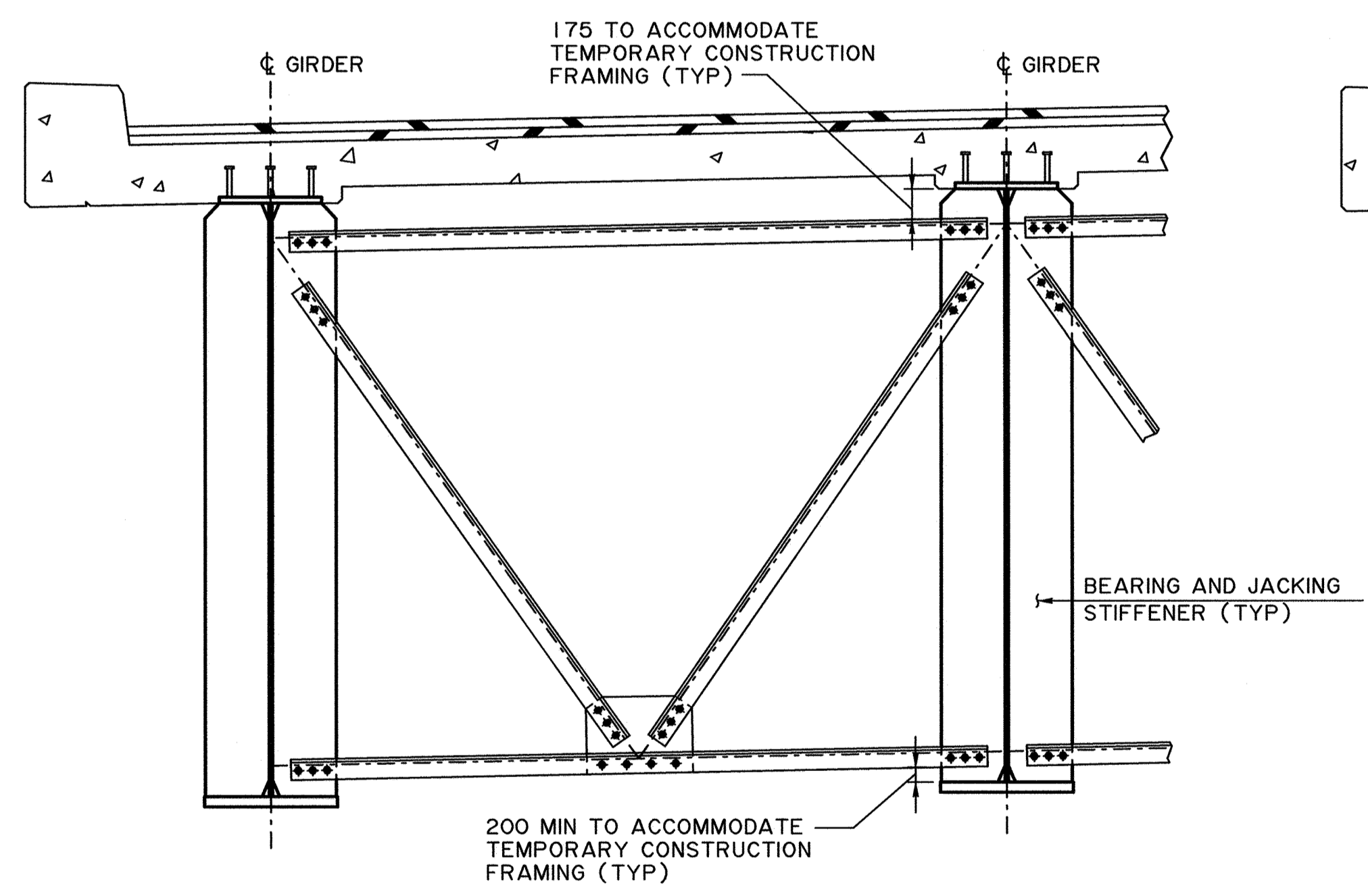

**K-BRACING DETAILS  
AT PIER DIAPHRAGM**

1:25

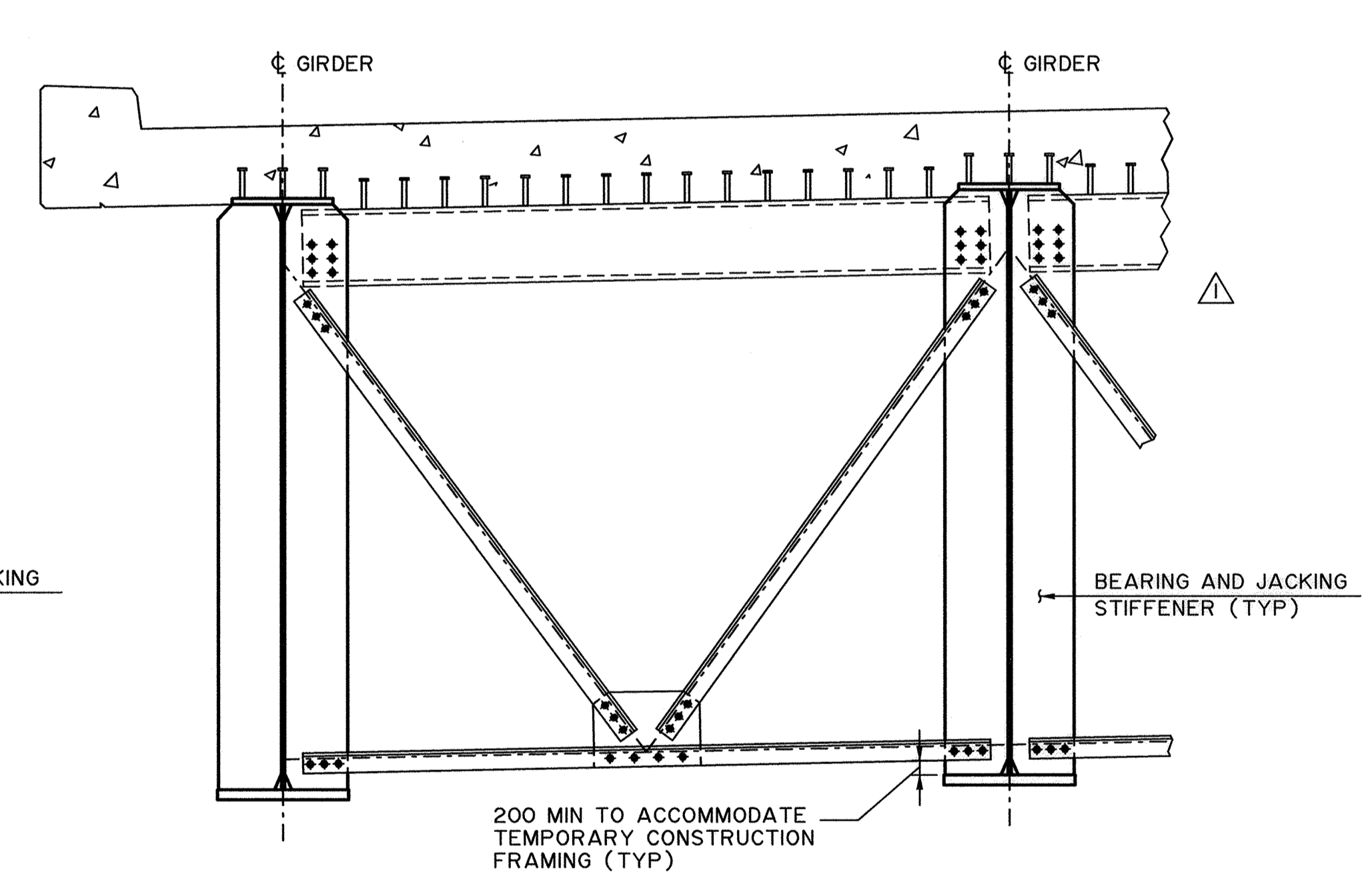

**K-BRACING DETAILS  
AT ABUTMENT DIAPHRAGM**

1:25

DETAILS SHOWN ARE CONCEPTUAL AND REPRESENT  
DEPARTMENT PRACTICES AS REFERENCED IN THE  
BRIDGE STRUCTURES DESIGN CRITERIA. FULL  
RESPONSIBILITY FOR DESIGN OF DETAILS REMAINS  
WITH THE CONSULTANT.

**NOT FOR CONSTRUCTION**

△				RECOMMENDED DIRECTOR BRIDGE ENGINEERING
△				
△				APPROVED EXECUTIVE DIRECTOR TECHNICAL STANDARDS BRANCH
△				
△	2012-01-18	ABUTMENT DIAPHRAGM LOWERED	CM	
REV	DATE	REVISIONS	BY	DATE

**Alberta** Transportation

**STEEL PLATE GIRDER BRIDGE  
TYPICAL DETAILS SHEET 1**

DATE	SHEET	DRAWING
2009-01-23	3 of 5	S-1759-08

NH 2012-01-18 S-1759-08-RVL.DGN