

**ABUTMENT DIAPHRAGM DETAIL**

1:10

**PIER DIAPHRAGM DETAIL**

1:10

BAR LIST: DIAPHRAGMS					
MARK	SIZE	TYPE	X	Y	LENGTH
D1001	10	A	160	640	1440
D1002C	10	A	160	640	1440
D1004C	10	R			1570
D1501C	15	STR			
D1502C	15	L	500	680	1180
D1503C	15	T	500	500	1000
D1504C	15	U	410	442 (450)	1430 (1560)
D2503	25	STR			

-SUFFIX LETTER " C " ON BAR MARK DENOTES EPOXY COATED BARS.  
 -MIN EPOXY COATED BEND: 10M = 80°  
 15M = 120°

**NOTE:**  
 • FOR DIMENSIONS THAT VARY WITH CURB HEIGHT, DIMENSIONS ARE GIVEN AS:  
 XXX FOR 350 CURB  
 (XXX) FOR 415 CURB

**BAR TYPES**

(ALL BAR DIMENSIONS ARE OUT TO OUT)

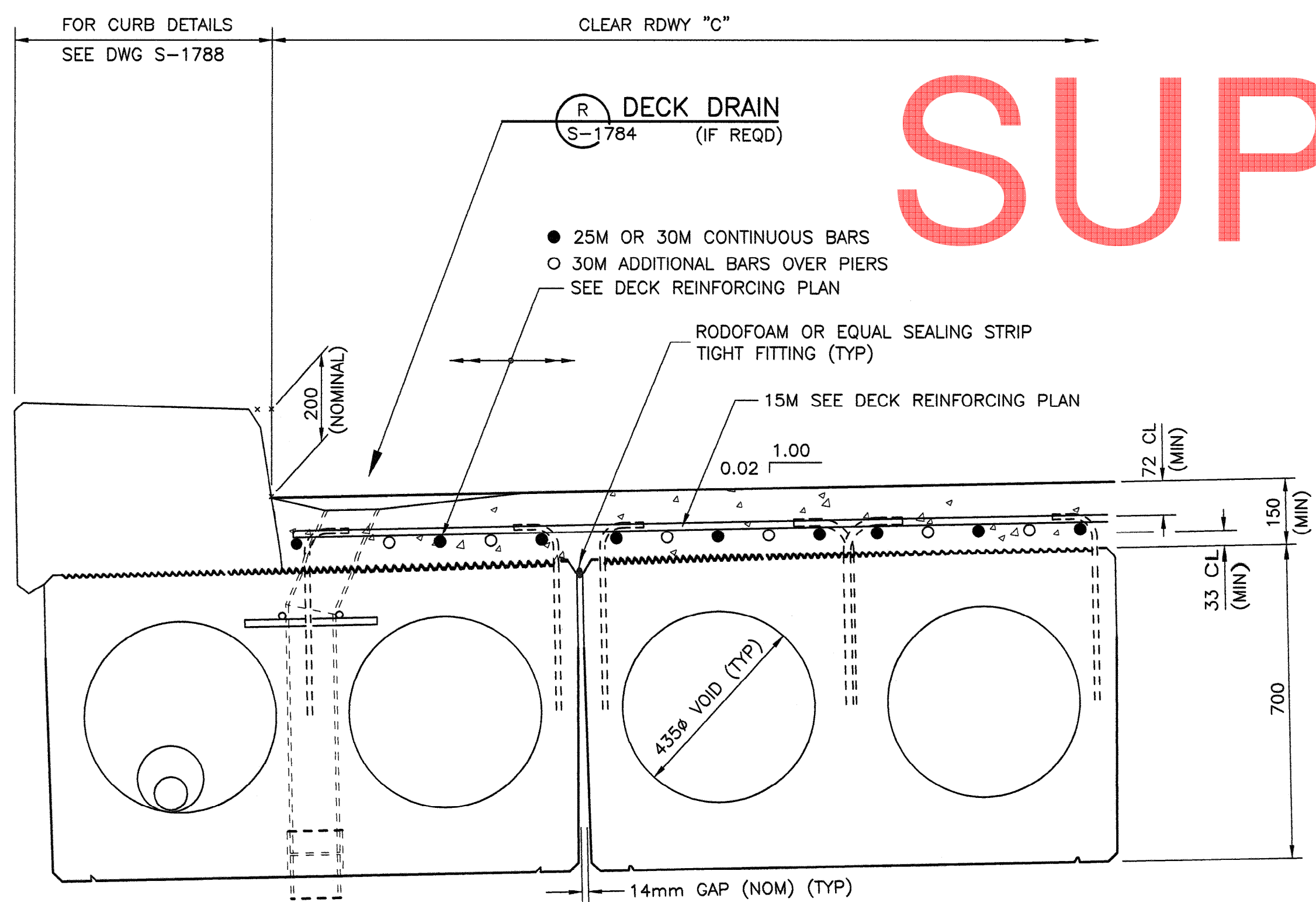
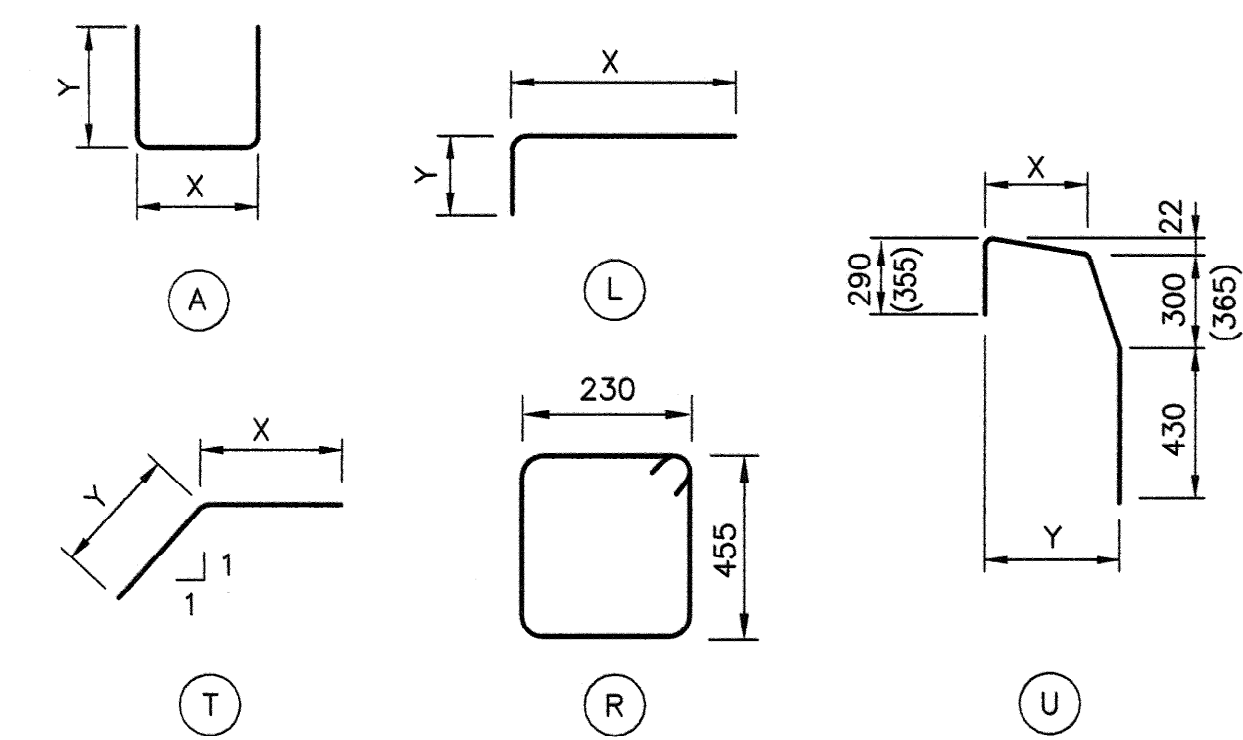

**A TYPICAL DECK SECTION**

S-1782 (FOR CONCRETE TO GRADE) 1:10

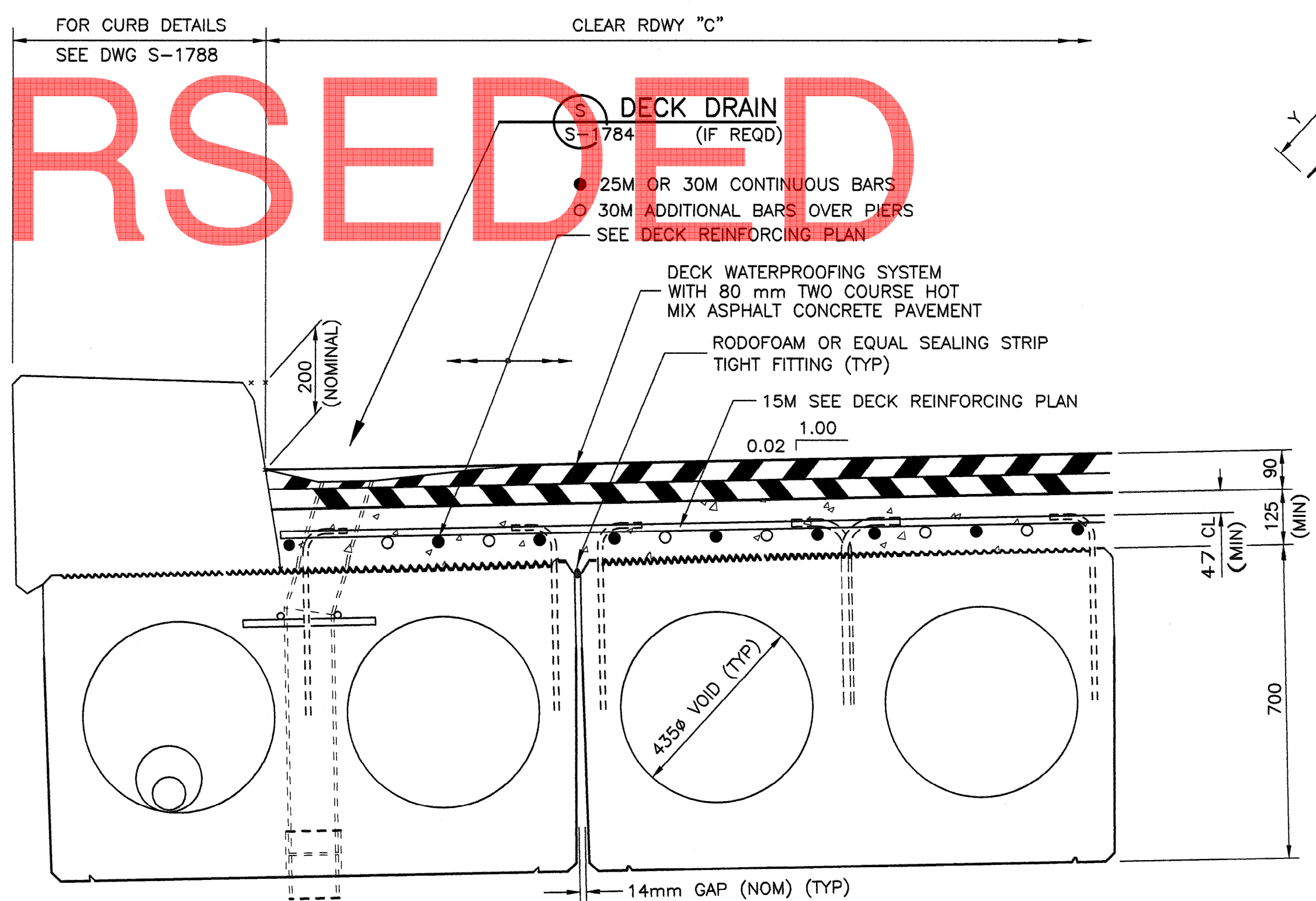

**B TYPICAL DECK SECTION**

S-1782 (FOR ACP WEARING SURFACE) 1:10

**SUPERSEDED**

**SUPERSEDED BY S-1783-08  
 REVISION 1, 2008-10-01**

• FOR GENERAL NOTES SEE DWG S-1782

NH AUG 18, 2008 S-1783-08.DWG -DRAWN-BY-RWK-

	<p><b>PERMIT TO PRACTICE</b>          ISL Engineering and Land Services Ltd.          Signature: [Signature]          Date: Aug 15, 2008          PERMIT NUMBER: P 4741          The Association of Professional Engineers, Geologists and Geophysicists of Alberta</p>	<p>DESIGNER</p>	<p>CHECKER</p>	<p>RECOMMENDED DIRECTOR BRIDGE ENGINEERING</p>	
		<p>APPROVED EXECUTIVE DIRECTOR TECHNICAL STANDARDS BRANCH</p>	<p>STANDARD SLC COMPOSITE BRIDGES          SLC700 PRESTRESSED CONCRETE GIRDERS          DECK DETAILS - SHEET 1</p>		
<p>DATE: Aug 15 108</p>		<p>DATE: Aug 15, 2008</p>		<p>DATE: Aug 22, 2008</p>	<p>DEPARTMENT BAR CODE: -</p>
<p>DATE: Aug 15 108</p>		<p>DATE: Aug 15, 2008</p>		<p>DATE: Aug 22, 2008</p>	<p>DATE: 2008-06-30</p>
<p>DATE: Aug 15 108</p>		<p>DATE: Aug 15, 2008</p>		<p>DATE: Aug 22, 2008</p>	<p>SHEET: 2 OF 7</p>
<p>DATE: Aug 15 108</p>		<p>DATE: Aug 15, 2008</p>		<p>DATE: Aug 22, 2008</p>	<p>DRAWING: S-1783-08</p>