

SURFACE STRUCTURE 1/4" = 1'-0"

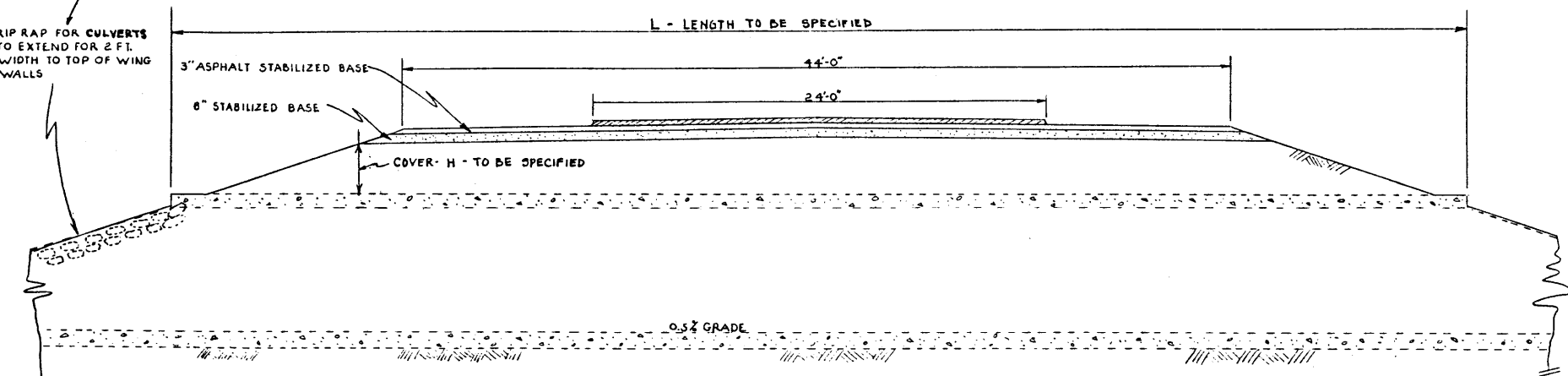

SUBSURFACE STRUCTURE 1/4" = 1'-0"

| BAR SCHEDULE FOR ONE SURFACE STRUCTURE | | | | | |
|--|-----|------|--------|-----------------------------------|------------------|
| MARK | No. | SIZE | LENGTH | SHAPE | WEIGHT |
| A10 | 98 | 3/8" | 9'-2" | | 1837 |
| A11 | 98 | 1/2" | 7'-10" | STRAIGHT | 513 |
| B10 | 196 | 3/8" | 8'-4" | | 1703 |
| B11 | 192 | 3/8" | 6'-5" | | 1285 |
| C10 | 48 | 1/2" | 24'-6" | STRAIGHT | 863 |
| C11 | 48 | 1/2" | | STRAIGHT (LENGTH TO BE SPECIFIED) | |
| W1 | 6 | 1/2" | 13'-4" | | 53 |
| W2 | 6 | 1/2" | 15'-4" | | 62 |
| W3 | 6 | 1/2" | 17'-4" | | 69 |
| W4 | 6 | 1/2" | 19'-4" | | 75 |
| W5 | 4 | 1/2" | 21'-4" | | 57 |
| W6 | 8 | 1/2" | 13'-9" | STRAIGHT | 73 |
| W7 | 4 | 1/2" | 10'-0" | " | 27 |
| W8 | 4 | 1/2" | 7'-0" | " | 19 |
| W9 | 4 | 1/2" | 4'-0" | " | 11 |
| F10 | 14 | 1/2" | 13'-9" | " | 127 |
| F11 | 28 | 1/2" | 7'-10" | " | 147 |
| TOTAL | | | | | 6924 LBS. |

SCHEDULE NOTE: ABOVE SCHEDULE IS FOR ONE SURFACE TYPE STRUCTURE. BAR SCHEDULE FOR SUBSURFACE TYPE STRUCTURE IS IDENTICAL EXCEPTING THAT THE NUMBER OF BARS MARKS A10, A11, B10, B11 IS TO BE SPECIFIED AND THAT THE LENGTHS OF C11 BARS TO BE SPECIFIED, AND THAT BARS A11 ARE OMITTED FOR COVER H GREATER THAN 1.5 FT.

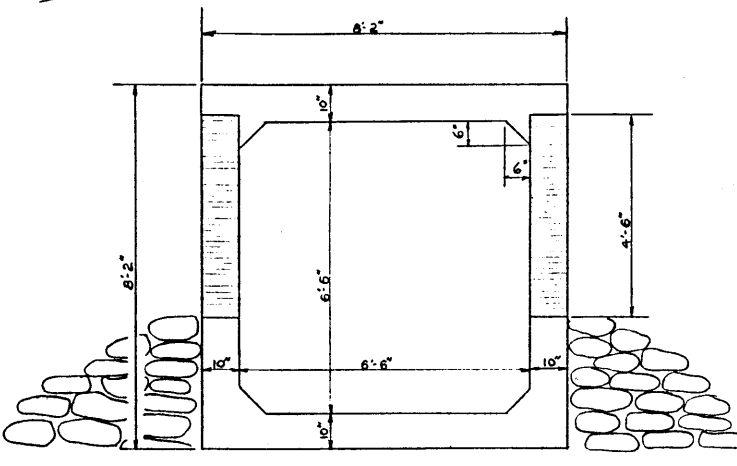

END ELEVATION

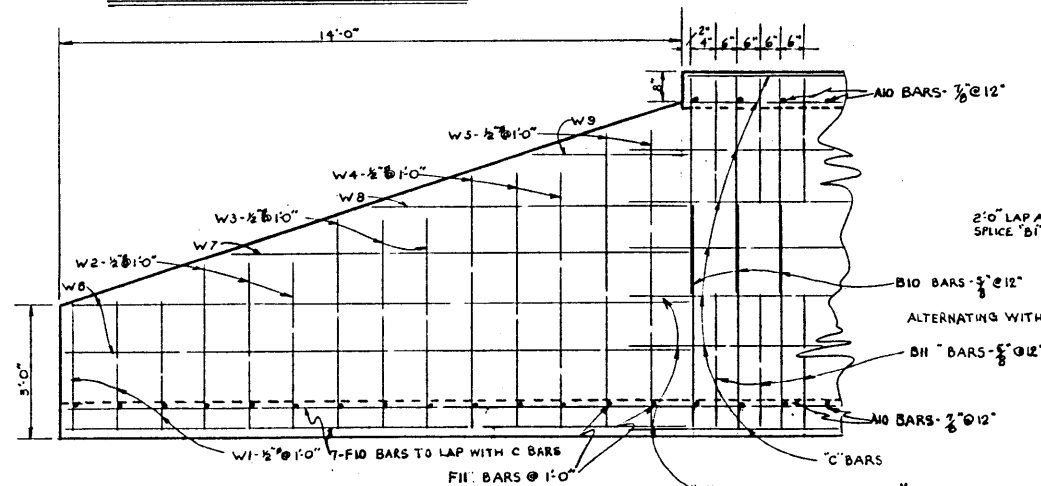

WING ELEVATION
(SAME FOR BOTH SURFACE AND SUBSURFACE STRUCTURES)

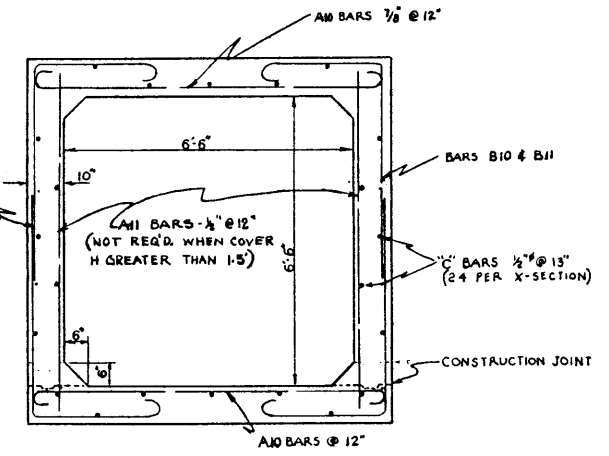

BARREL SECTION

- GENERAL NOTES:**
- MIN. STEEL COVER TO BE 1 1/2 INCHES.
 - ALL CONCRETE TO BE CLASS "A" 3000 P.S.I. AT 28 DAYS.
 - MAX. SIZE COARSE AGGREGATE TO BE 2 INCHES.
 - ALL CORNERS TO HAVE 1" CHAMFERS OR FILLETS UNLESS OTHERWISE SPECIFIED.
 - GRADE AND LINE TO BE SET IN FIELD BY ENGINEER.
 - FOUNDATION TO SATISFACTION OF ENGINEER.
 - SEE DWG 802-P FOR LOCATIONS.

DESIGNED BY: W.T.G. DATE: _____
 CHECKED BY: E.T.S. DATE: _____
 DETAILED BY: E.C.H. DATE: _____
 DATE: OCT. 30 1952
 DATE: NOV. 5 1952

| ESTIMATED QUANTITIES | | |
|----------------------|--------------------------|-----------------|
| TYPE | CONCRETE | STEEL |
| SURFACE | 59.50 CU. YDS. | 6924 LBS. |
| SUBSURFACE | 15.20 + 0.923 L CU. YDS. | TO BE SPECIFIED |

| NO. | DATE | DESCRIPTION | BY |
|-----|------------|---------------------------------------|--------|
| 1 | JAN. 14/52 | TITLE REV. TO INCLUDE CULVERTS | E.I.S. |
| 2 | JAN. 14/52 | NOTES ADDED - BARS A11 ADDED. | E.I.S. |
| 3 | JAN. 14/52 | BAR MARKS REVISED - BARS A10 REVISED. | E.I.S. |

TRANS-CANADA HIGHWAY

STANDARD CONCRETE CULVERT

& STOCK UNDERPASSES

GOVERNMENT OF THE PROVINCE OF ALBERTA
DEPARTMENT OF PUBLIC WORKS
BRIDGE BRANCH, EDMONTON

FILE NO. _____ HWY. NO. _____ T.C.H. _____ DWG. NO. _____
 LOCATION _____ SCALE 1/2" = 1'-0" _____ S-528
 STREAM _____ SHEET 2 OF 2 _____

AT & U - RECORDS CENTRE