

**CULVERT FILE NO. 7334 and 8919**  
**SWEPT BACK WING REINFORCING SCHEDULE - 4 WINGS**

MARK	TYPE	CULVERTS 3'-6" HIGH			CULVERTS 6'-6" HIGH			CULVERTS 6'-6" HIGH					
		No	Size	Length Space	No	Size	Length Space	No	Size	Length Space			
F1	Curved	8	1/2	8'-4"	2'	4	1/2	10'-6"	2'	8	1/2	13'-11"	2'
F2	"	8	1/2	6'-0"	1'-0"	8	1/2	8'-4"	1'-0"	8	1/2	12'-0"	1'-0"
F3	"	4	1/2	3'-5"	1'-0"	4	1/2	6'-2"	1'-0"	4	1/2	7'-3"	1'-0"
F4	"	4	1/2	3'-7"	2'	4	1/2	2'-0"	1'-0"	4	1/2	4'-6"	1'-0"
F5	"	12	1/2	3'-7"	10"	12	1/2	4'-4"	2'	12	1/2	5'-9"	2'
F6	"	16	1/2	2'-10"	1'-0"	16	1/2	4'-4"	0"	16	1/2	5'-9"	9"
F7	"	4	1/2	1'-11"	1'-0"	12	1/2	4'-0"	10"	20	1/2	5'-10"	10"
F8	"	12	1/2	5'-0"	1'-0"	12	1/2	3'-0"	1'-0"	8	1/2	3'-7"	1'-0"
F9	"	4	1/2	2'-1"	1'-0"	4	1/2	2'-1"	1'-0"	8	1/2	2'-4"	1'-0"
F10	"	4	1/2	6'-5"	2'	4	1/2	1'-9"	2'	4	1/2	1'-10"	1'-0"
V1	"	4	1/2	6'-4"	10"	4	1/2	7'-6"	7"	4	1/2	9'-7"	2'
V2	"	4	1/2	3'-0"	5'-9"	4	1/2	7'-11"	10"	4	1/2	6'-0"	4 1/2"
V3	"	4	1/2	5'-9"	4'-11"	4	1/2	6'-8"	10"	4	1/2	9'-2"	4 1/2"
V4	"	4	1/2	4'-0"	4'-0"	4	1/2	6'-8"	10"	4	1/2	6'-0"	4 1/2"
V5	"	4	1/2	4'-0"	4'-0"	4	1/2	6'-8"	10"	4	1/2	8'-11"	4 1/2"
V6	"	4	1/2	4'-0"	4'-0"	4	1/2	5'-9"	1'-0"	4	1/2	8'-6"	7"
V7	"	4	1/2	4'-0"	4'-0"	4	1/2	5'-9"	1'-0"	4	1/2	8'-4"	7"
V8	"	4	1/2	3'-0"	3'-0"	4	1/2	5'-9"	1'-0"	4	1/2	8'-1"	7"
V9	"	4	1/2	6'-5"	2'	4	1/2	4'-4"	1'-0"	4	1/2	8'-1"	7"
V10	"	4	1/2	6'-5"	2'	4	1/2	4'-4"	1'-0"	4	1/2	7'-10"	7"
V11	"	4	1/2	6'-5"	2'	4	1/2	4'-4"	1'-0"	4	1/2	1'-5"	10"
V12	"	4	1/2	6'-5"	2'	4	1/2	6'-5"	1'-0"	4	1/2	7'-1"	10"
V13	"	4	1/2	6'-5"	2'	4	1/2	6'-5"	1'-0"	4	1/2	6'-7"	10"
V14	"	4	1/2	6'-5"	2'	4	1/2	6'-5"	1'-0"	4	1/2	6'-2"	10"
V15	"	4	1/2	6'-5"	2'	4	1/2	6'-5"	1'-0"	4	1/2	5'-3"	10"
V16	"	4	1/2	6'-5"	2'	4	1/2	6'-5"	1'-0"	4	1/2	5'-3"	10"
V17	"	4	1/2	6'-5"	2'	4	1/2	6'-5"	1'-0"	4	1/2	4'-9"	10"
V18	"	4	1/2	6'-5"	2'	4	1/2	6'-5"	1'-0"	4	1/2	4'-9"	10"
H1	Curved	4	1/2	6'-0"	1'-6"	4	1/2	9'-5"	1'-6"	4	1/2	13'-0"	1'-6"
H2	"	4	1/2	5'-1"	1'-6"	4	1/2	7'-5"	1'-6"	4	1/2	10'-11"	1'-6"
H3	"	4	1/2	1'-11"	1'-6"	4	1/2	4'-2"	1'-6"	4	1/2	7'-7"	1'-6"
H4	"	4	1/2	11'	1'-6"	4	1/2	11'	1'-6"	4	1/2	4'-3"	1'-6"
H5	"	4	1/2	5'-3"	2"	4	1/2	6'-3"	2"	4	1/2	0'-11"	1'-6"
H6	"	4	1/2	4'-0"	3'-0"	4	1/2	5'-0"	3'-0"	4	1/2	6'-3"	2"
H7	"	4	1/2	2'-9"	3'-0"	4	1/2	3'-8"	3'-0"	4	1/2	6'-11"	3'-0"
H8	"	4	1/2	2'-9"	3'-0"	4	1/2	2'-5"	3'-0"	4	1/2	5'-6"	3'-0"
H9	"	4	1/2	8'-0"	1'-6"	4	1/2	10'-3"	1'-6"	4	1/2	4'-2"	3'-0"
H10	"	4	1/2	5'-0"	1'-6"	4	1/2	8'-0"	1'-6"	4	1/2	2'-9"	3'-0"
H11	"	4	1/2	2'-3"	1'-6"	4	1/2	4'-6"	1'-6"	4	1/2	2'-9"	3'-0"
H12	"	4	1/2	2'-3"	1'-6"	4	1/2	1'-0"	1'-6"	4	1/2	11'-4"	1'-6"
H13	"	4	1/2	2'-3"	1'-6"	4	1/2	1'-0"	1'-6"	4	1/2	11'-4"	1'-6"
H14	"	4	1/2	2'-3"	1'-6"	4	1/2	1'-0"	1'-6"	4	1/2	5'-0"	1'-6"
H15	"	4	1/2	2'-3"	1'-6"	4	1/2	1'-0"	1'-6"	4	1/2	4'-9"	1'-6"
H16	"	4	1/2	2'-3"	1'-6"	4	1/2	1'-0"	1'-6"	4	1/2	1'-3"	1'-6"
Total Steel Wt											543 lb	1,125 lb	

NOTE: Reinforcing schedule is for 4 wings (ie for 2 complete entrances)

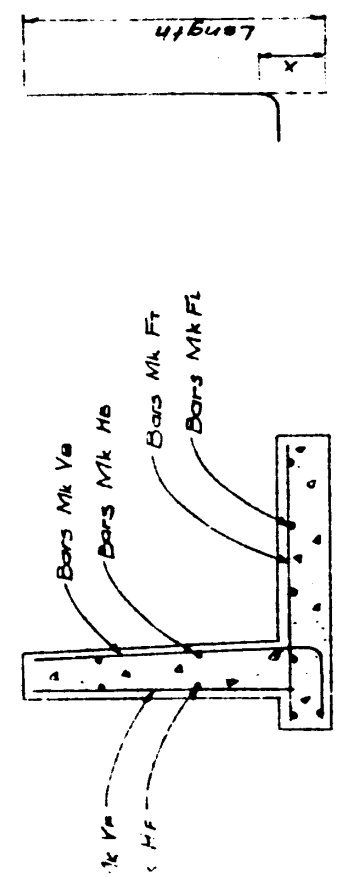

TYPICAL RIGHT X-SECTION THROUGH WING  
 TYPE A BAR

**DETAILS OF SWEEP BACK WING ENTRANCE FOR STANDARD CONCRETE BOX CULVERTS**

GOVERNMENT OF THE PROVINCE OF ALBERTA  
 DEPARTMENT OF HIGHWAYS  
 BRIDGE BRANCH, EDMONTON  
 FILE NO. 8919 & 7334 HWY. NO. 6-A SCALE 1/8" = 1'-0"  
 DRAWING NO. 5-538