

	MARK	Nº REQ'D	SIZE	TYPE	DIM' X	DIM' Y	SPACING	LENGTH	WEIGHT
MAX COVER 5'-0"	R8	5	A	5'-8	13'-8	1'-2	25'-0		
	S8	5	B	3'-3	5"	1'-2	21'-0		
	V8	4	STR			1'-2	9'-2		
	H	4	STR			AS SHOWN			
	T8	4	STR			4'-8	13'-8		
MAX COVER 8'-0"	R8	6	A	5'-11	14'-2	9"	26'-0		
	S8	6	C	3'-6	8"	9"	23'-8		
	V8	4	STR			1'-6	9'-8		
	H	4	STR			AS SHOWN			
	T8	4	STR			5'-0	14'-2		

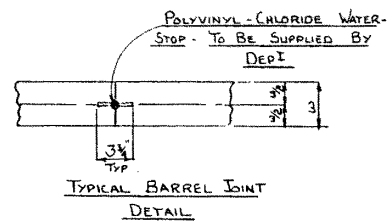
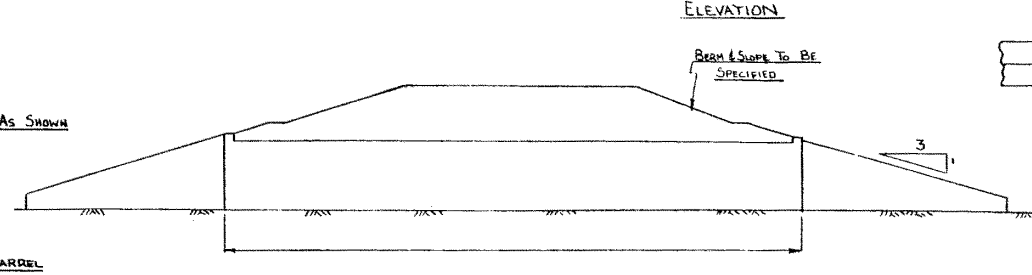
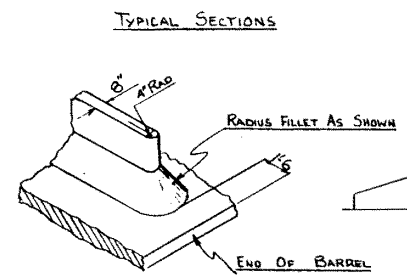

THREE CELL 6 x 8 CULVERTS									
	MARK	No. Req'd	SIZE	TYPE	DIM' X	DIM' Y	SPACING	LENGTH	WEIGHT
MAX COVER 10' T=8" W=8"	R8	5	D	5'-8	20'-5	1'-2	31'-9		
	S8	5	E	3'-2	5"	1'-2	28'-7		
	V8	4	Str.			1'-2	9'-0		
	H	4	Str.			AS SHOWN			
	T8	4	Str.			4'-8	20'-5		

VIEW SHOWING ENDS OF INNER WALL - (SIMILAR TOP & BOTTOM)

SECTION SHOWING JOINT SPACING (MAX SPACING 39'-0)

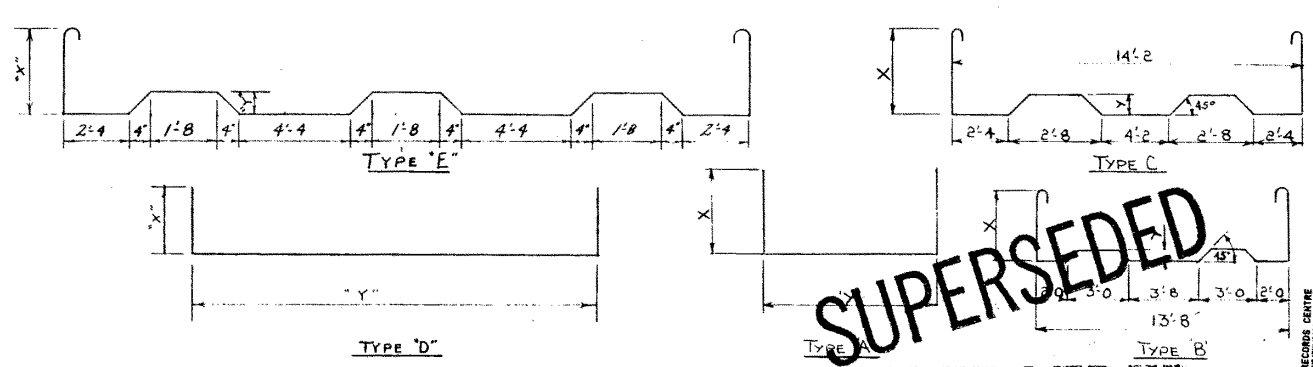
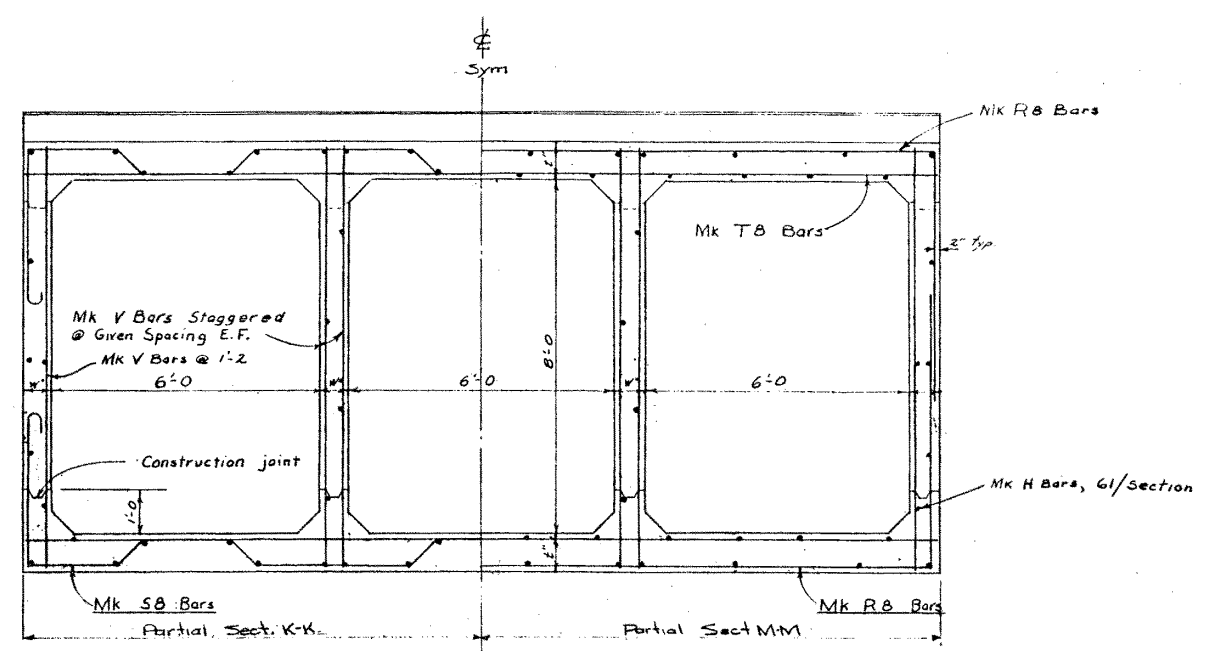

- NOTES
1. BAR DIMENSIONS OUT TO OUT
  2. FOR DETAILS OF APRONS & WINGWALLS SEE DWG # 5598
  3. ALL HOOKED BARS TO BE SUPPLIED WITH 'MINIMUM' HOOKS.

NO.	DATE	DESCRIPTION	BY
1	SEP 6, 55	3 Cell Culvert Detail Added	J.P.W.
2	JULY 7 '55	25' Cover table added	D.R.

**SUPERSEDED**  
**SUPERSEDED**

DOUBLE CELL 6x8 CULVERTS  
TRIPLE CELL 6x8 CULVERTS

GOVERNMENT OF THE PROVINCE OF ALBERTA  
DEPARTMENT OF HIGHWAYS  
BRIDGE BRANCH, EDMONTON

FILE NO. \_\_\_\_\_ HWY. NO. \_\_\_\_\_ DWG. NO. 5 608-9  
LOCATION. \_\_\_\_\_ SCALE \_\_\_\_\_ SHEET \_\_\_\_\_ OF \_\_\_\_\_  
STREAM \_\_\_\_\_

PREPARED BY: \_\_\_\_\_ DATE: \_\_\_\_\_  
 CHECKED BY: \_\_\_\_\_ DATE: \_\_\_\_\_  
 DRAWN BY: \_\_\_\_\_ DATE: \_\_\_\_\_