

BRIDGE BRANCH

DEPARTMENT OF HIGHWAYS

TRAFFIC SIGNS TO BE USED ON BRIDGE PAINTING PROJECTS WITH TWO WAY TRAFFIC MAINTAINED

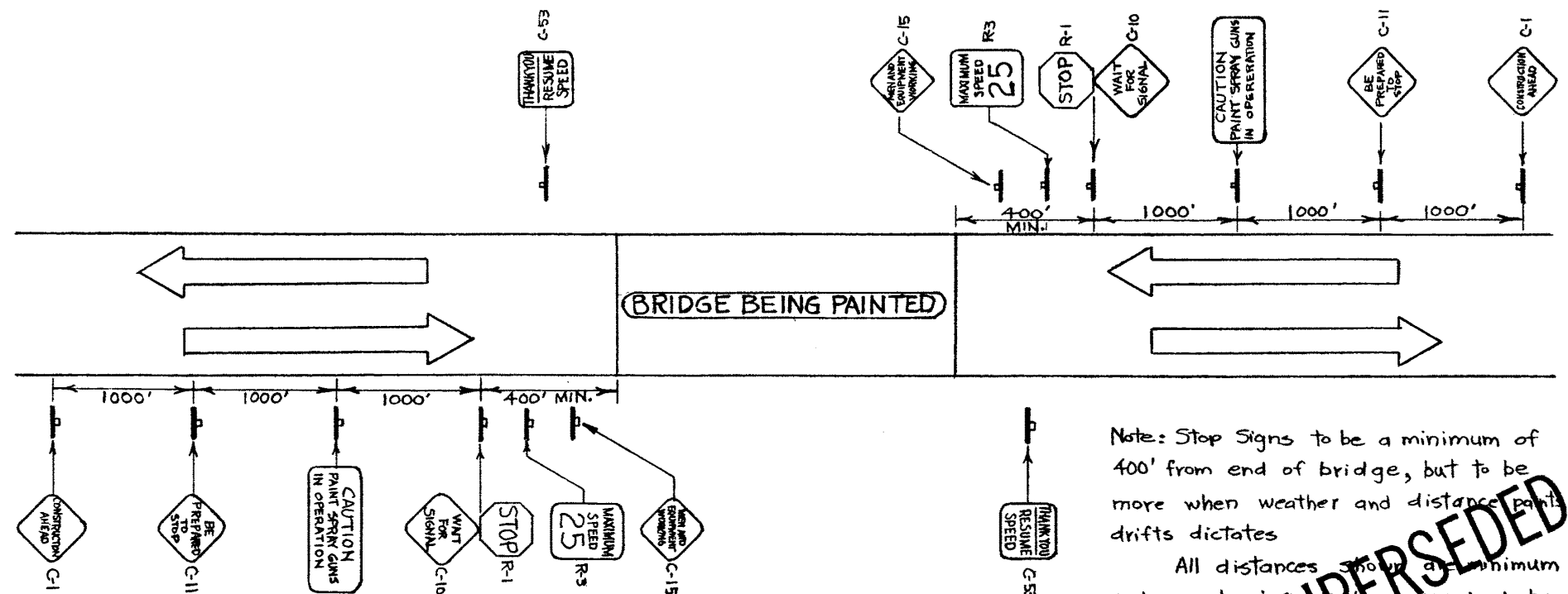

Note: Stop Signs to be a minimum of 400' from end of bridge, but to be more when weather and distance paint drifts dictates

All distances shown a minimum and may be increased as required by conditions.

SUPERSEDED

S-763-A

NOV. 1, 1961

AT & U - RECORDS CENTRE

F199878

Superseded by dwg. S 763C
DWG. 5763A