

BRIDGE BRANCH

DEPARTMENT OF HIGHWAYS

TRAFFIC SIGNS TO BE USED ON BRIDGE PAINTING PROJECTS WITH ONE WAY TRAFFIC

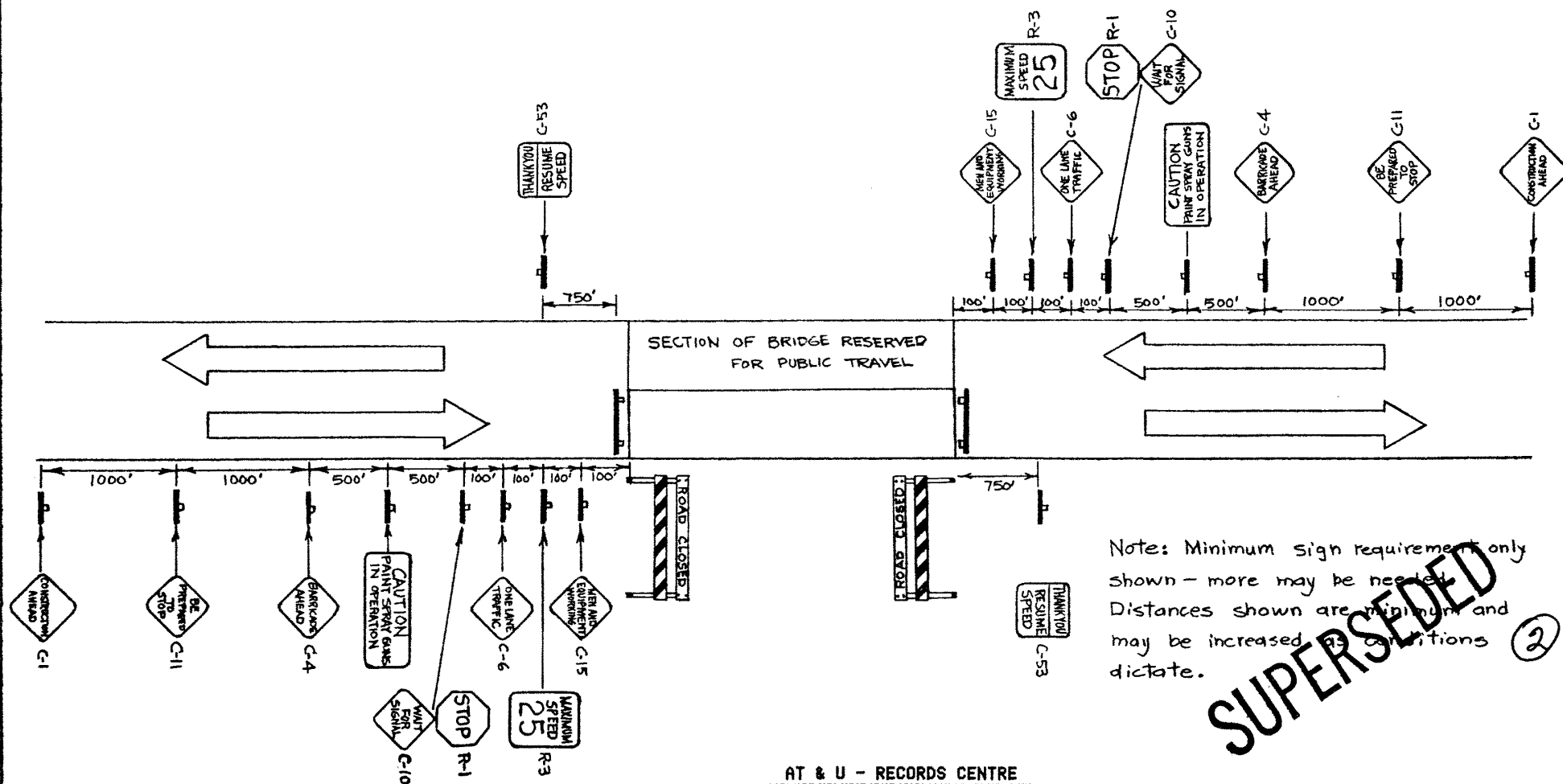

Note: Minimum sign requirements only shown - more may be needed. Distances shown are minimum and may be increased as conditions dictate.

SUPERSEDED

S-763-B

NOV. 1, 1961

AT & U - RECORDS CENTRE
F199871

Superseded by dwg. S 763 C
DWG. 5763 B