

GENERAL NOTES

- DESIGN**
- AASHO. 1961 specifications except, live load is as shown below. Dead Load includes 2" wearing surface.
- MATERIALS**
- All concrete materials shall conform to A.S.T.M specifications.
 - Concrete shall be of standard weight aggregate with max. # size X" min. # compressive strength shall be 4500 p.s.i at 28 days. Entrained air shall fall between the limits of 5.5- 1%.
 - Reinforcing steel shall be of intermediate grade conforming to the C.S.A. specification G30.1 - 1954, and deformed to conform to the specification G30.6 - 1954.

FABRICATION

- Concrete must reach 30% of the required 28 day compressive strength before stripping and lifting.
- Concrete must reach 65% of the required 28 day compressive strength before shipping.
- Each girder shall have a poured camber of 1/4"
- All acute corners on skewed girders to have X" chamfer.
- Diameters of all bends shall conform to the recommended minimums, and all hooks, unless otherwise noted shall conform to the recommended sizes details in the A.C.I Manual of Standard Practice for Detailing Reinforced Concrete Structures.
- Concrete test cylinders shall be tested by an independent testing laboratory, copies of all test results shall be forwarded to the Bridge Branch.
- Tests shall be taken at the rate of one cylinder for each two stringers with not less than two cylinders for each day's pouring.

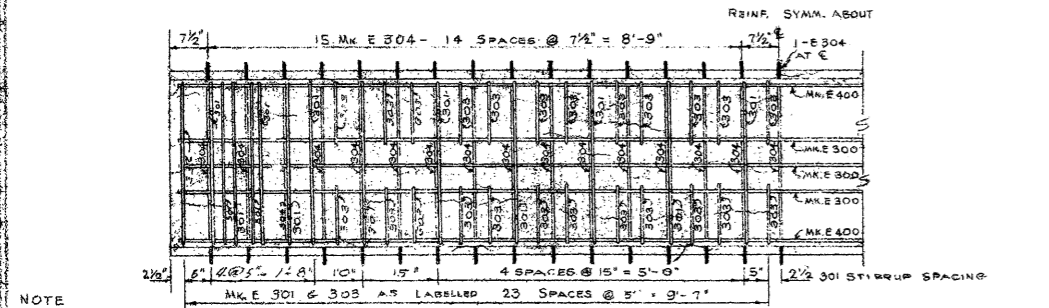

[S 20] INTERIOR STRINGER

MARK	No.	SIZE	SKETCH	OUT TO OUT DIMENSION	LENGTH	REMARKS
E 300	3	3/8"	STR.	19'-8"	19'-8"	CAN BE SPICED WITH 12" LAP
E 301	22	3/8"	STR.	2'-7 1/2"	5'-1"	
E 303	48	3/8"	STR.	1'-0"	1'-4"	
E 304	31	3/8"	STR.	3'-3"	3'-10"	
E-336	2	3/8"	STR.	2'-6"	9'-2"	
E 400	2	1/2"	STR.	19'-8"	19'-8"	CAN BE SPICED WITH 12" LAP
E 501	4	5/8"	STR.	2'-7"	2'-7"	
E 906	2	1 1/8"	STR.	18'-2"	18'-0"	
E 907	2	1 1/8"	STR.	19'-8"	22'-2"	
TOTAL REIN STEEL PER UNIT						254.9#

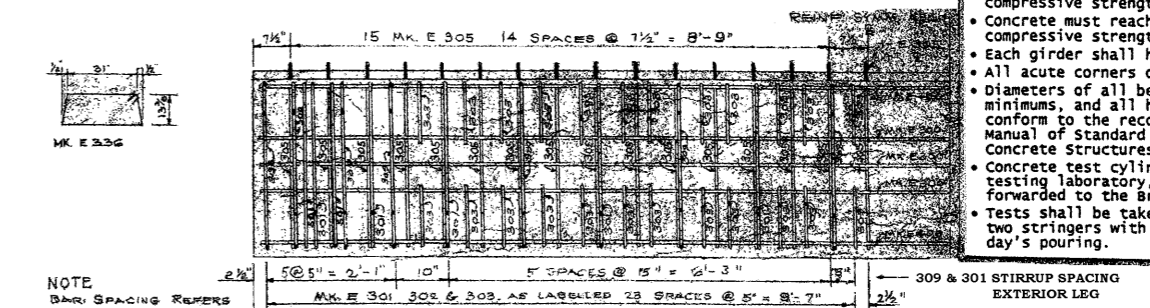

[CS 20]-EXTERIOR STRINGER

MARK	No.	SIZE	SKETCH	OUT TO OUT DIMENSION	LENGTH	REMARKS
E 300	3	3/8"	STR.	19'-8"	19'-8"	CAN BE SPICED WITH 12" LAP
E 301	11	3/8"	STR.	2'-7 1/2"	5'-1"	
E 336	2	3/8"	STR.	2'-8"	8'-2"	
E 303	48	3/8"	STR.	1'-0"	1'-4"	
E 305	31	3/8"	STR.	3'-0"	3'-7"	
E 306	6	3/8"	STR.	4'-2"	4'-2"	
E 309	11	3/8"	STR.	2'-8"	7'-5"	
E 400	2	1/2"	STR.	19'-8"	19'-8"	CAN BE SPICED WITH 12" LAP
E 501	4	5/8"	STR.	2'-7"	2'-7"	
E 1004	1	1 1/2"	STR.	17'-10"	18'-4"	EXT. LEG
E 907	2	1 1/8"	STR.	19'-8"	22'-2"	EXT. LEG
E 906	1	1 1/8"	STR.	18'-2"	19'-0"	INT. LEG
E 907	1	1 1/8"	STR.	19'-8"	22'-2"	INT. LEG
TOTAL REIN STEEL PER UNIT						548.3#

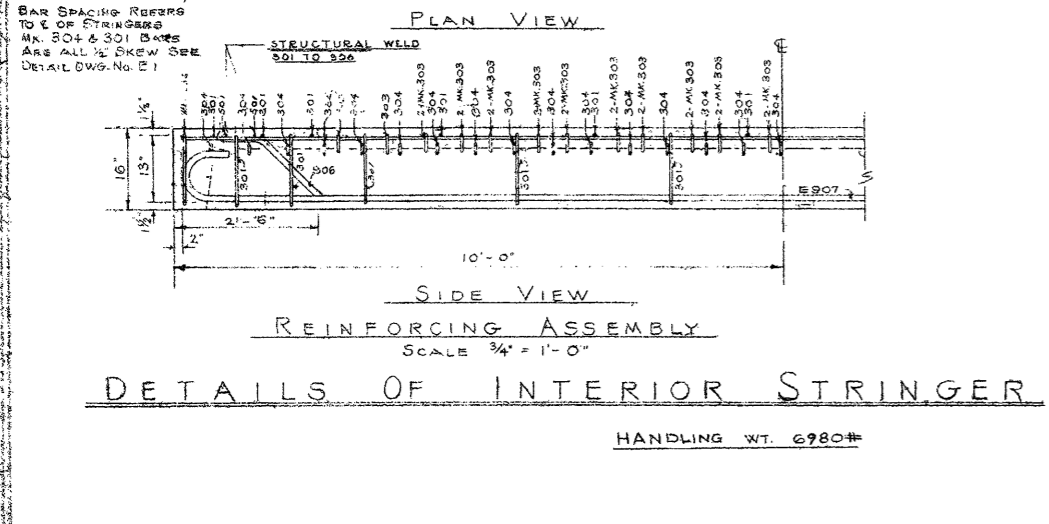
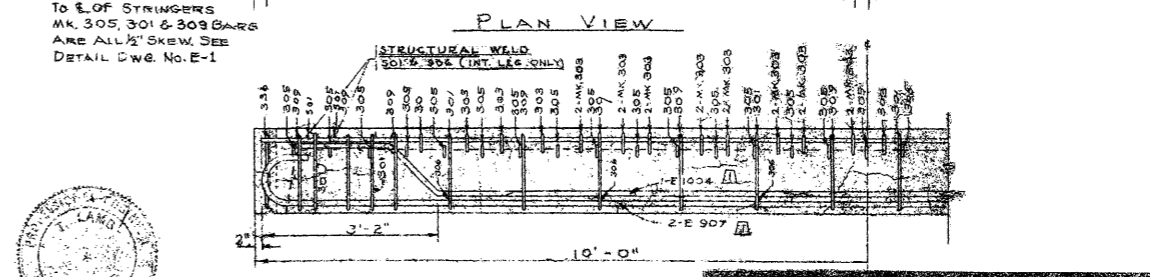

PRECAST CONCRETE
20 FT SPAN TYPE 'E'
INTERIOR STRINGER

GOVERNMENT OF THE PROVINCE OF ALBERTA
DEPARTMENT OF HIGHWAYS
BRIDGE BRANCH, EDMONTON

FILE NO. _____ HWY. NO. _____ DWG. NO. _____
LOCATION _____ SCALE AS SHOWN _____ SHEET _____ OF _____
STREAM _____

NO.	DATE	DESCRIPTION	BY

HANDLING WT. 7280#