

△ SIGN LIGHTING WIRING DIAGRAM N.T.S.

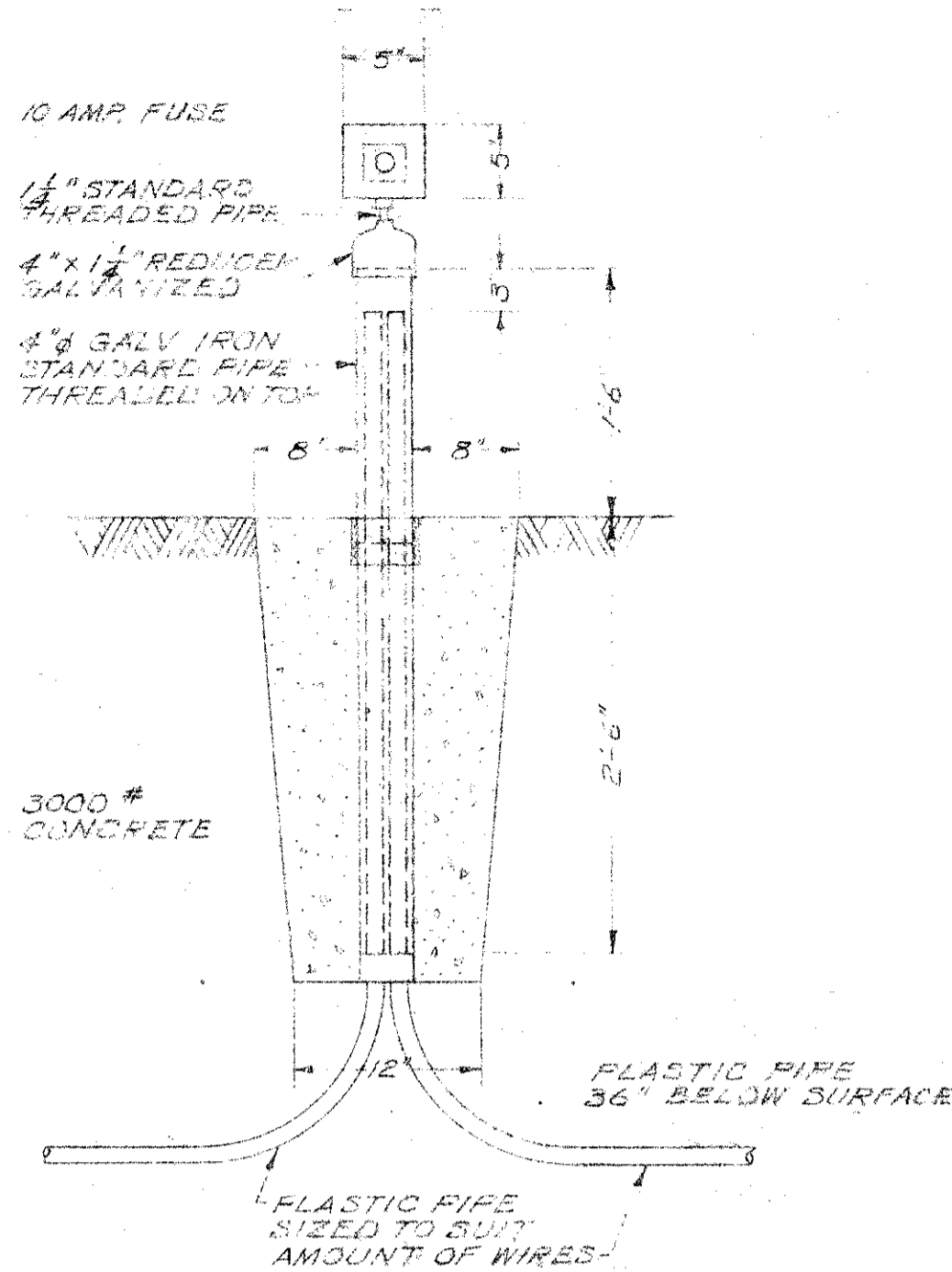

△ TYPICAL CAR PLUG BOX TYPE-A N.T.S.

SYMBOLS

- (A) Ceiling outlet with fixture type "A"
- (B) Wall outlet with fixture type "B"
- (C) Fluorescent fixture
- (D) Lamp type "C"
- (E) Duplex convenience outlet
- (F) Thermostat
- (G) Transformer
- (H) Motor
- (I) Junction box
- (J) Telephone outlet
- S Single pole switch
- Sp. Switch and pilot light
- ◇ Thermal switch
- Conduit in floor
- Home run to panel. No. of arrows shows no. of circuits.
- Panel
- Telephone cabinet

GENERAL NOTES

FIXTURE LIST

- △ A "WILSON" MODULUX 1' x 4' - RECESSED IN CEILING - CAT. No. F962-M12 2-40W P.S.
- B "WILSON" CB 110 WALL BRACKET 100 W.
- C "MOLDCAST" LAMP HOLDER CAT. No. MLA-501 WITH PAR-38 100 W. FLOOD LAMP.
- D "CROUSE-HINDS" WALL BRACKET CAT. No. VB1753 - 100W.

RELAY FOR SIGN #1 SHALL BE "POTTER & BRUMFIELD" PR SERIES 2PST-N.O. 15A CONTACTS - 115 V. AC COIL - 60 CYCLE.

NOTE

- △ 1. SCALE HOUSE PANEL & METERING SHALL BE LOCATED AS SHOWN, OR ON OPPOSITE WALL TO OBTAIN SHORTEST DISTANCE OF MAIN FEEDER RUN TO POWER SUPPLY. SAME APPLIES TO TEL. SERVICE.
- 2. POWER SUPPLY FOR SCALE SHALL BE 120 V. FLOOR OUTLET AS SHOWN, OR SHALL BE AS PER REQUIREMENTS.
- △ 3. HEATING CABLES CONTROLLED BY TWO SWITCHES. TWO CABLES REQ'D. EQUAL TO PYROTEX 177 FT. LONG, 800 W. 120V EACH. LOCATE WITHIN ONE INCH OF SURFACE. USE EXCESS CABLE AT 4 CORNERS, EQUAL AMOUNT AT EACH.
- △ 4. LIGHTING CONTACTOR SHALL BE 120 VOLTS - 5 POLE, SIZE 1 WITH ON-OFF SWITCH AND PILOT LIGHT CONTROL TO BE WIRED IN SERIES WITH PHOTOCELL.
- △ 5. WORK BY OTHERS WILL BE ARRANGED AND PAID FOR BY THE DEPARTMENT.
- △ 6. FLOOR CONDUITS FOR PUBLIC ADDRESS SYSTEM AND TELEPHONE TO BE LOCATED TO SUIT POSITION OF SCALE CONSOLE.

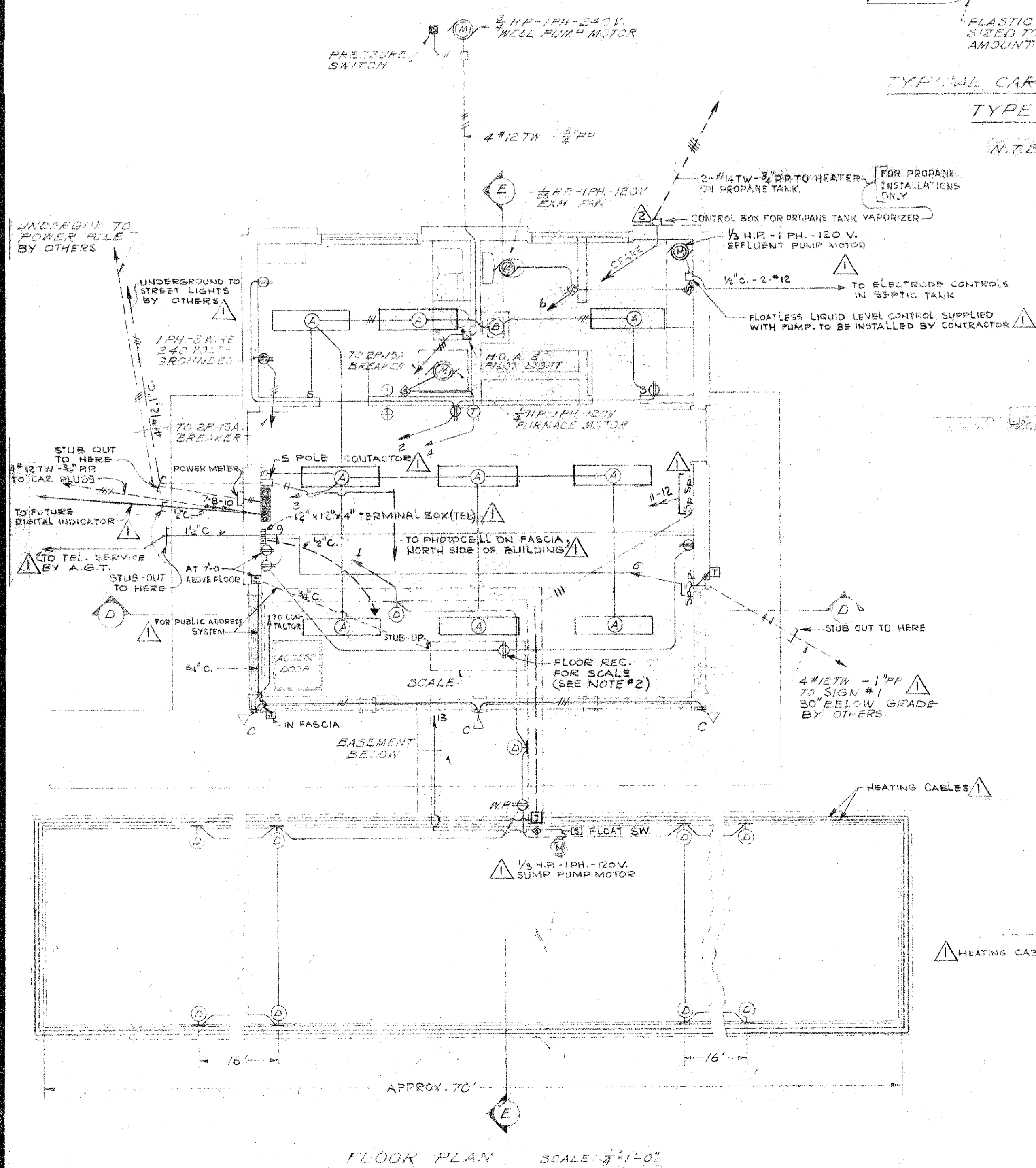

△ FLOOR PLAN SCALE: 1/4" = 1'-0"

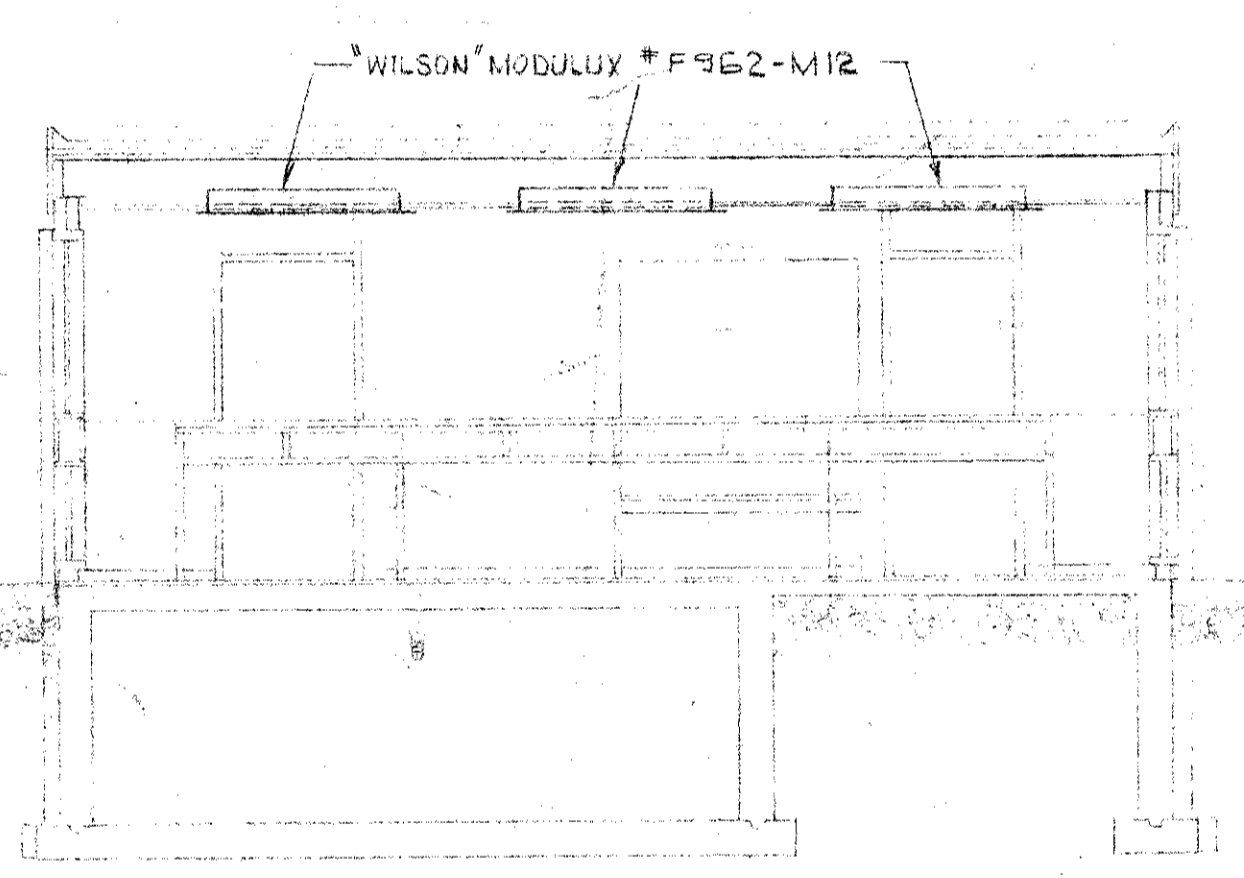

△ SCALE HOUSE PANEL N.T.S.

SECTION D-D SCALE 1/4" = 1'-0"

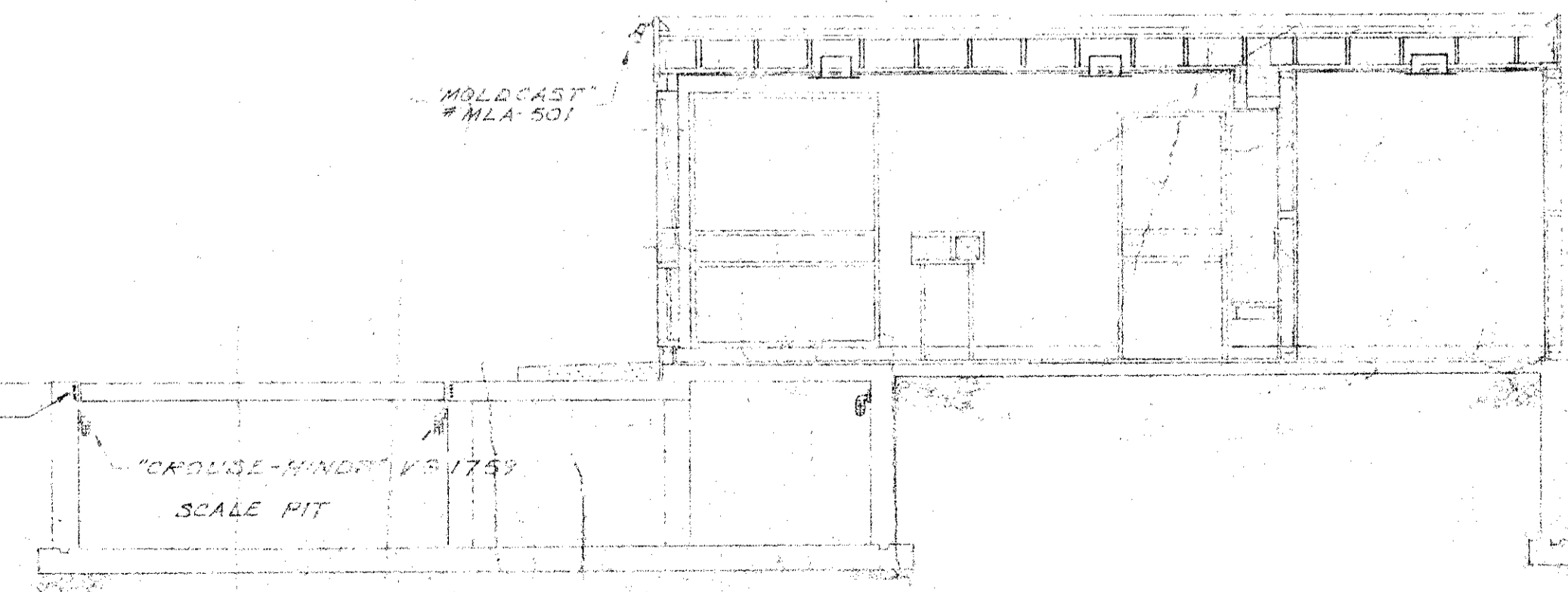

SECTION E-E SCALE 1/4" = 1'-0"

DESIGNED BY
DATE 19
DETAILED BY
DATE 19
CHECKED BY
DATE 19

SUPERSEDED
BY DWG. 5999-71 JUNE 71

WEIGH SCALE STATION

ELECTRICAL

GOVERNMENT OF THE PROVINCE OF ALBERTA
DEPARTMENT OF HIGHWAYS
BRIDGE BRANCH, EDMONTON

NO.	DATE	DESCRIPTION	BY
1	Sep. 8/69	Breakers and propane vaporizer wiring I.R.C.	I.R.C.
2	July 25/71	General	I.R.C.

FILE NO. 5235
SCALE AS SHOWN
SHEET OF 8-999

