GP 2 - Hwy 40:38 Kakwa River

20 km S. of Kakwa River

Instrumentation Monitoring Report (Fall 2003) • Slope Indicator Data

**EBA Engineering Consultants Ltd.
0107-7100131.003
December 2003**

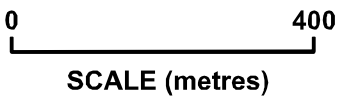
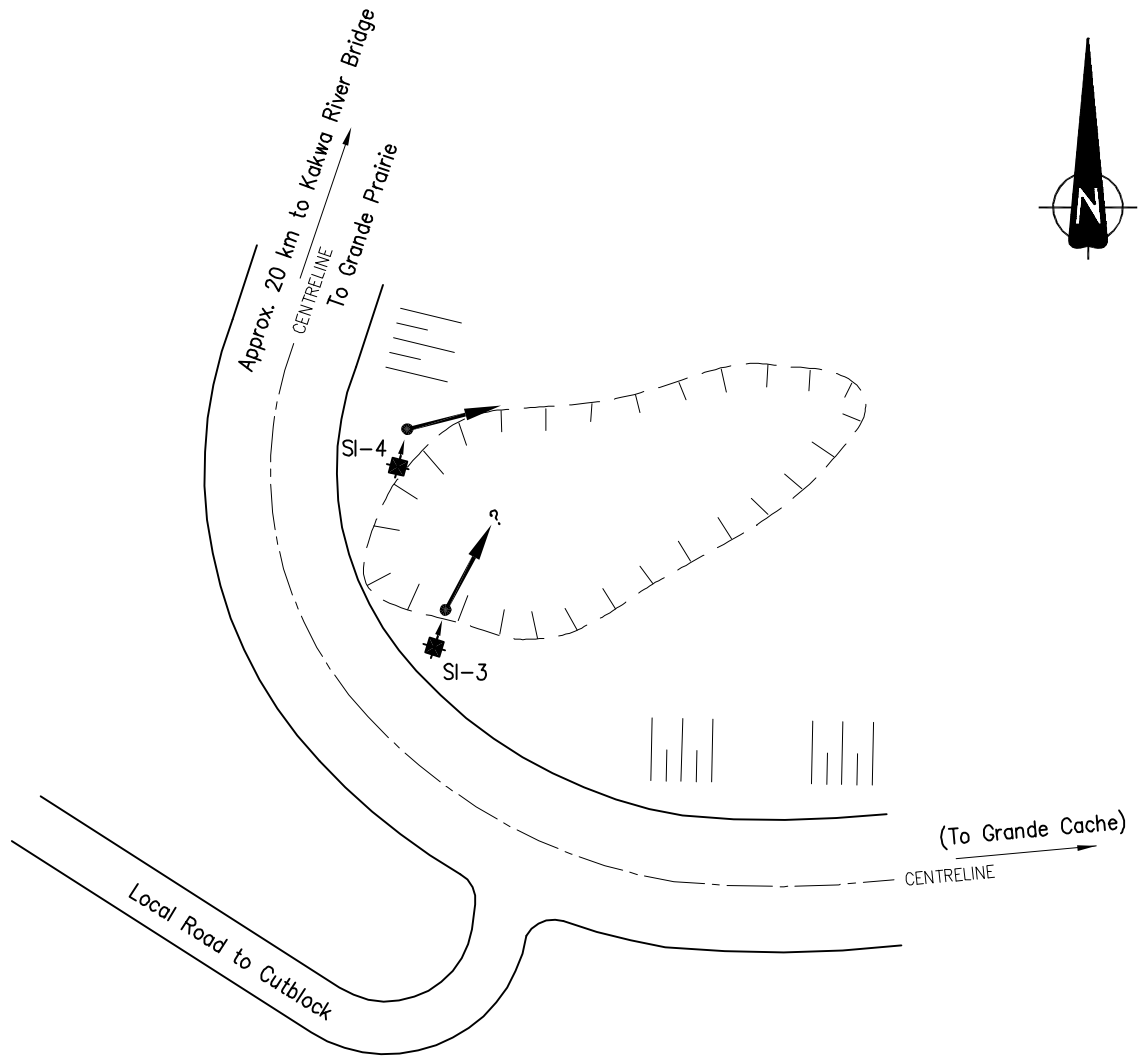

Figure 1
1993 Aerial Photograph



LEGEND:

- 'A+'
■ — SLOPE INDICATOR LOCATION AND DIRECTION OF 'A+' GROOVE
- ↑ — DIRECTION OF MOVEMENT

NOT TO SCALE

Figure 2
Site Plan
Existing Instrumentation



**Kakwa Slide
Hwy 40:38 (GP-2)
Listing of Slope Indicator Readings**

SI-#	Kakwa03	Kakwa04																		Comments
Stick-up	0.56 m	0.78 m																		
Azimuth of A+ Groove	5°	6°																		
Ground Elevation (m)	493.6	496.6																		
Reading Depth m (ft)	21.0 m (69')	21.0 m (69')																		
Jun 12 '97	√	√																		
Oct 5 '97	√	√																		
May 22 '98	√	√																		
Sep 25 '98	√	√																		
Oct '99	√	√																		
June '00	√	√																		
Oct '00	√	√																		
June 5 '01	√	√																		
Oct 3 '01	√	√																		
May 22 '02	√	√																		
Sep 23 '02	√	√																		
Jun 11 '03	√	√																		
Sep 23 '03	√	√																		

Legend: √ data acquired and processed
 * shear movement depth (m)
 ** SI casing sheared-off depth (m)
 *** SI casing broken & needs repair